

Bletchley Library

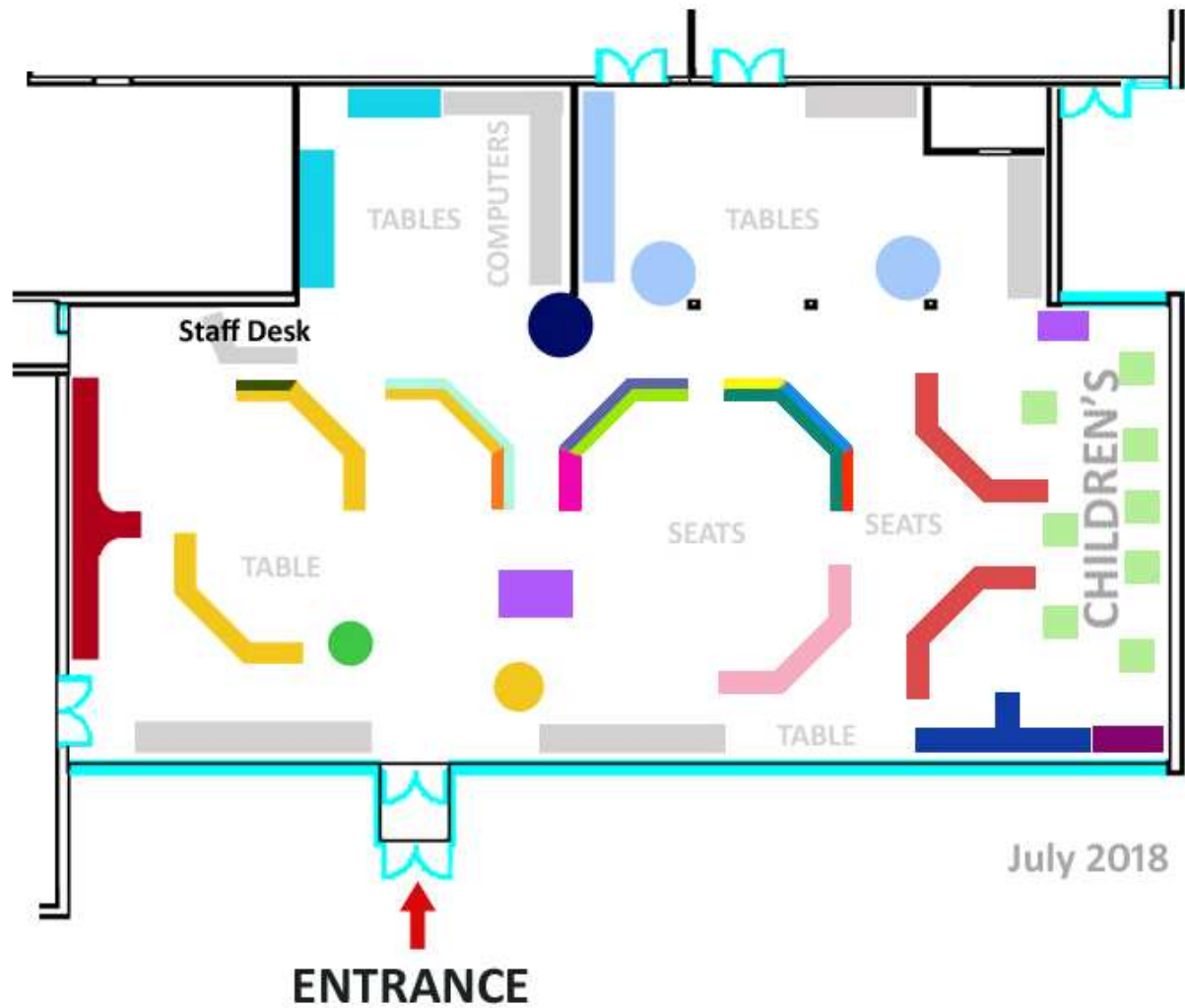

- | | | |
|---|--|---|
| ● Adult Non-Fiction | ● Magazines | ● Sci-Fi/Fantasy |
| ● Parent's Shelf | ● Horror | ● Romance |
| ● Picture/Board Books | ● Crime/Action/Thrillers | ● Photocopier |
| ● Children's Fiction | ● Teen | ● Large Print |
| ● Adult Fiction | ● Community Languages | ● Self-Service Kiosks |
| ● Audiobooks | ● Children's Non-Fiction | ● Graphic Novels |
| ● History/Local History | ● Reservations | ● Westerns |
| | ● Biographies | |