

A5 North Arm Visibility Splays

**IMPORTANT:**  
Preliminary general arrangement only for visual representation of further mitigation provided by BWB. Existing proposals taken from CH2MHILL PDF drawing (481893.01 GA01 rev 2) and scaled into AutoCAD

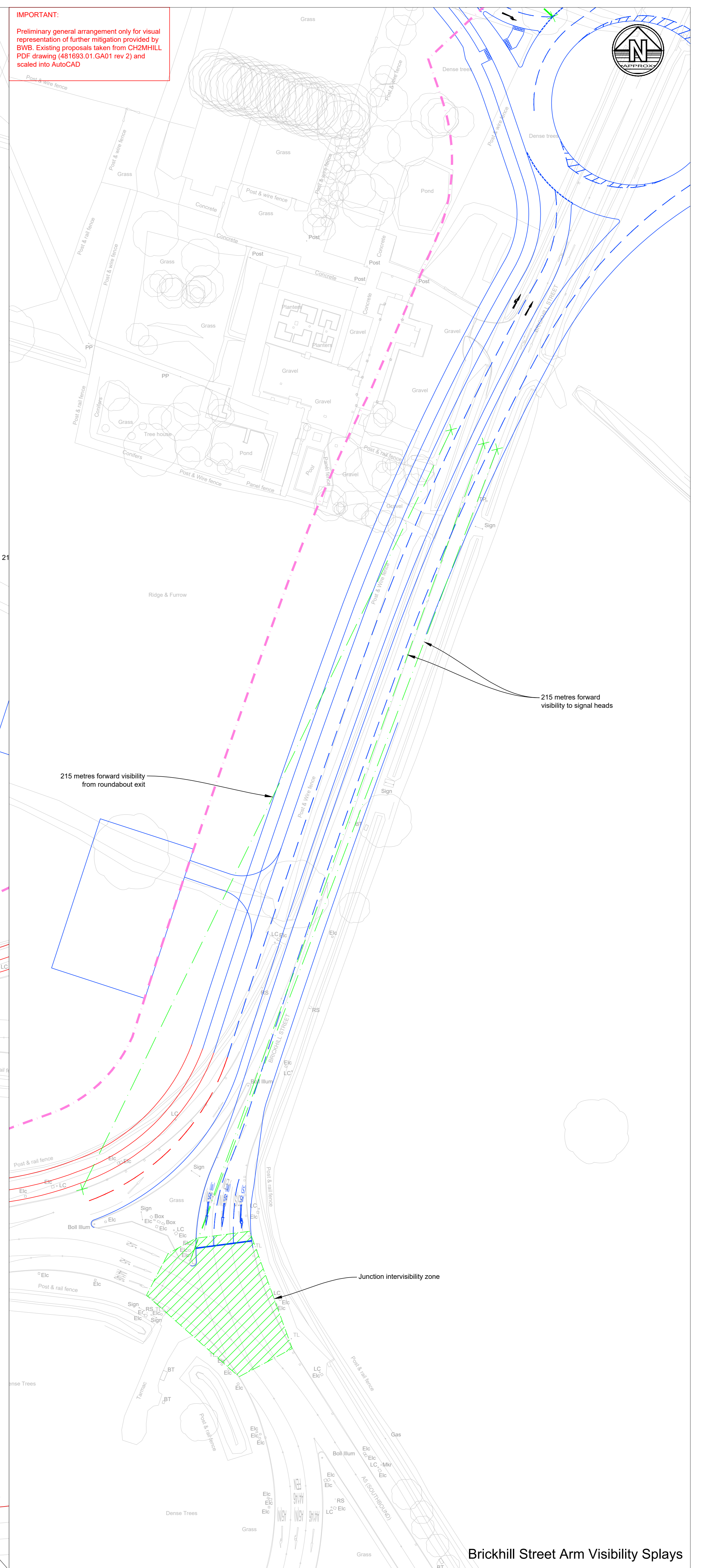

A5 South Arm Visibility Splays

Brickhill Street Arm Visibility Splays

- Notes**
- Do not scale this drawing. All dimensions must be checked/verified on site. If in doubt ask.
  - This drawing is to be read in conjunction with all relevant architects, engineers and specialist drawings and specifications.
  - All dimensions in millimetres unless noted otherwise. All levels in metres unless noted otherwise.
  - Any discrepancies noted on site are to be reported to the engineer immediately.

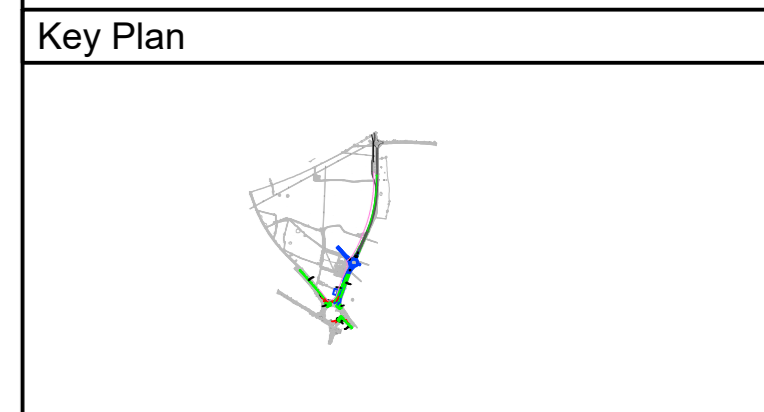

- Legend**
- Changes required to existing layout to accommodate South Caldecotte proposed traffic impact
  - Changes required existing layout to facilitate dualling of Brickhill Street between A5 and proposed site access roundabout
  - New extents of public highway
  - Primary Signal Head
  - Secondary Signal Head
  - Junction intervisibility zone

Rev	Date	Details of issue / revision	Drw	Rev
P3	08.07.20	Further detail added to proposals for HE	AJO	MA
P2	02.07.20	Winning revised to retain central reservation/VRS	AJO	MA
P1	18.06.20	Preliminary Issue	AJO	MA

**BWB**  
CONSULTANCY | ENVIRONMENTAL  
INFRASTRUCTURE | BUILDINGS

Birmingham | 0121 233 3322  
 Leeds | 0113 233 8000  
 London | 020 7407 3879  
 Manchester | 0161 233 4280  
 Nottingham | 0115 924 1100  
[www.bwbconsulting.com](http://www.bwbconsulting.com)

**Client**  
HB (South Caldecotte) Ltd

**Project Title**  
South Caldecotte, Milton Keynes

**Drawing Title**  
Proposed Kelly's Kitchen Roundabout Mitigation Visibility Splays

Drawn:	AJ Oakes	Reviewed:	M Addison
BWB Ref:	NTS 2682	Date:	18.06.20
Scale:	1:500	Scale:	1:500
<b>PRELIMINARY</b>			
Project - Originator - Zone - Level - Type - Role - Number	SCD-BWB-GEN-01-SK-TR-SK03	Status	S2
Rev			P3