



KEY

- Tree to be Retained
- Tree to be removed to facilitate the proposals
- Category U - Recommended for management or removal on arboricultural grounds see report for details
- Root Protection Area (Shown for retained trees only)
- T1 (A)
T01 (A)

Individual / Group Number and BS Category

NOTES

All dimensions to be verified on site. Do not scale this drawing. All discrepancies to be clarified with project Arboriculturalist. Drawing to be read in conjunction with Arboricultural Assessment and Appendix A - Tree Schedule.

Drawing produced in colour, a monochrome copy should not be relied upon, and is based on digital information supplied by the client in dwg format. The exact position of trees are to be checked and verified on site prior to construction.

Trees are living organisms that change over time, the condition of all trees illustrated herein, are to be checked by a qualified arboriculturalist or tree surgeon should works commence 12 months after the time of this survey. Please note that no works should be undertaken to any trees illustrated herein without first obtaining the proper authorisation to do so.

This drawing is the property of FPCR Environment and Design Ltd and is issued on the condition it is not reproduced, retained or disclosed to any unauthorised person, either wholly or in part without written consent of FPCR Environment and Design Ltd.

Ordnance Survey material is used with the permission of The Controller of HMSO, Crown copyright 100018886.

rev	date	description	by
---	15.10.12	First Issue	NGJ
A	28.02.14	SWMK03 - 077 - A - Illustrative Master Plan	EC
B	21.05.14	Amend scale and layout	NGJ
C	06.11.14	Updated layout	NGJ

fpcr

masterplanning
environmental assessment
landscape design
urban design
ecology
architecture
arboriculture

FPCR Environment and Design Ltd
Lockington Hall
Lockington
Derby DE74 2RH

t: 01509 672772
f: 01509 674565
e: mail@fpcr.co.uk
w: www.fpcr.co.uk

client
David Lock Associates

project
**SWMK
Milton Keynes**

drawing title
**TREE RETENTION AND REMOVAL PLAN
FIGURE 3**

scale
1:2500 @ A1

drawn
EC

date
November 2014

drawing number
3126-A-03.1

rev
C

CAD file: J:\3100\3126\Arboriculture\2012\Plans\Fig 3 Tree Retention Plan REV A.dwg

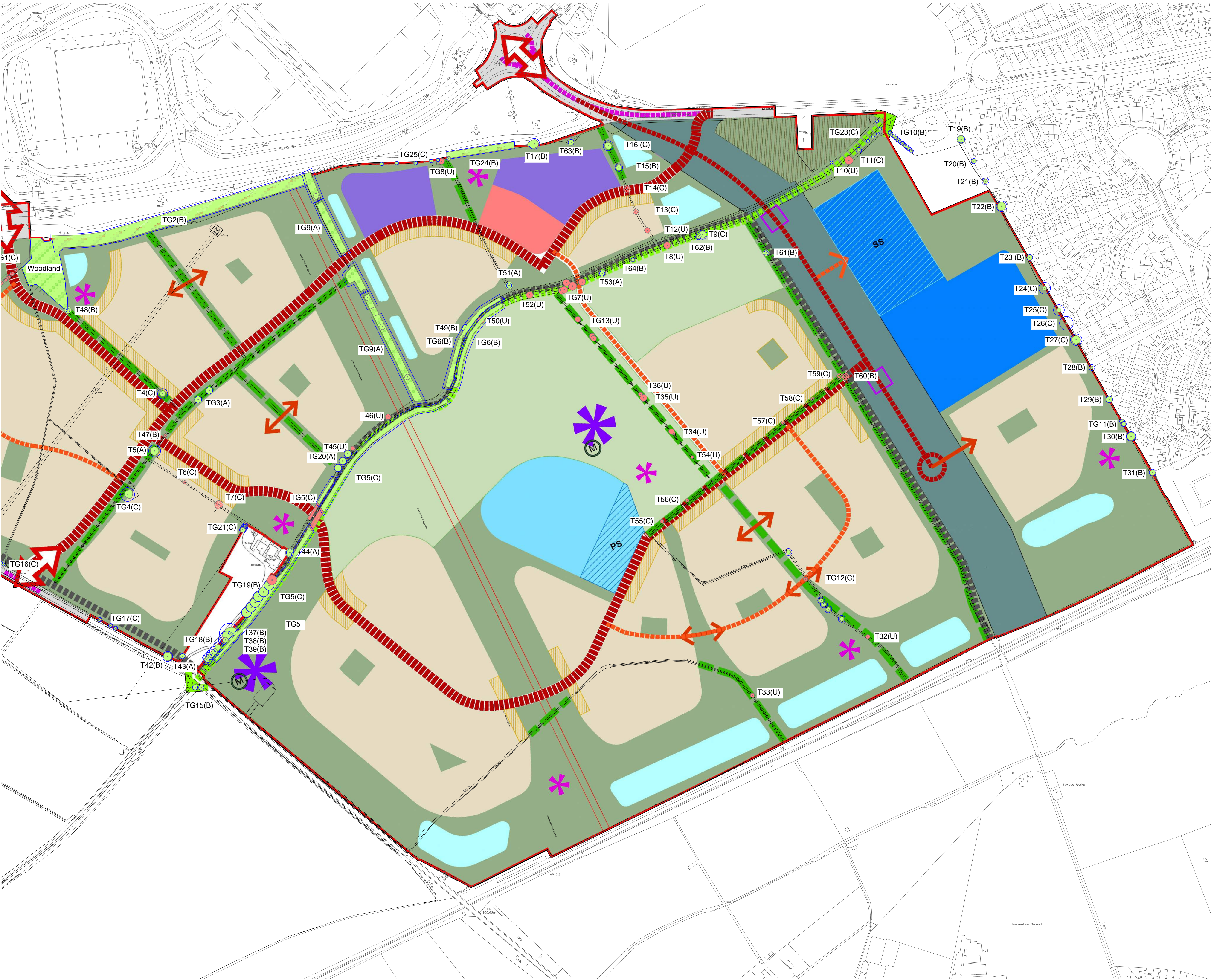

- KEY
- Tree to be Retained
 - Tree to be removed to facilitate the proposals
 - Category U - Recommended for management or removal on arboricultural grounds see report for details
 - Root Protection Area (Shown for retained trees only)
 - Individual / Group Number and BS Category



NOTES

All dimensions to be verified on site. Do not scale this drawing. All discrepancies to be clarified with project Arboriculturalist. Drawing to be read in conjunction with Arboricultural Assessment and Appendix A - Tree Schedule.

Drawing produced in colour, a monochrome copy should not be relied upon, and is based on digital information supplied by the client in dwg format. The exact position of trees are to be checked and verified on site prior to construction.

Trees are living organisms that change over time, the condition of all trees illustrated herein, are to be checked by a qualified arboriculturalist or tree surgeon should works commence 12 months after the time of this survey. Please note that no works should be undertaken to any trees illustrated herein without first obtaining the proper authorisation to do so.

This drawing is the property of FPCR Environment and Design Ltd and is issued on the condition it is not reproduced, retained or disclosed to any unauthorised person, either wholly or in part without written consent of FPCR Environment and Design Ltd.

Ordnance Survey material is used with the permission of The Controller of HMSO, Crown copyright 100018886.

---	15.10.12	First Issue	SWMK03 - 077 - A - Illustrative Master Plan	NGJ
A	28.02.14			EC
B	21.05.14	Amend scale and layout		NGJ
C	06.11.14	Updated Layout		NGJ
rev	date	description		by

- masterplanning
- environmental assessment
- landscape design
- urban design
- ecology
- architecture
- arboriculture

FPCR Environment and Design Ltd
Lockington Hall
Lockington
Derby DE74 2RH

t: 01509 672772
f: 01509 674565
e: mail@fpcr.co.uk
w: www.fpcr.co.uk

client
David Lock Associates

project
SWMK
Milton Keynes

drawing title
TREE RETENTION AND REMOVAL PLAN
FIGURE 3

scale
1:2500 @ A1

drawn
EC

date
November 2014

drawing number
3126-A-03.2

rev
C

CAD file: J:\3100\3126\Arboriculture\2012\Plans\Fig 3 Tree Retention Plan REV A.dwg