

MILTON KEYNES CITY COUNCIL (VARIOUS ROADS, MILTON KEYNES) (PROHIBITION OF WAITING) ORDER 2023

Milton Keynes City Council ("the Council") in exercise of its powers under Sections 1(1), 2(1) and (2) to (3), 4(2), 32(1), 35(1) and (3), and Part IV of Schedule 9 of the Road Traffic Regulation Act 1984 ("the Act of 1984") and of all other enabling powers, and after consultation with the Chief Officer of Police in accordance with Part III of Schedule 9 to the Act of 1984, hereby makes the following Order:

PART 1

IMPLEMENTATION, CITATION, DEFINITIONS AND REVOCATIONS

1. This Order shall come into operation on the day of 2023 and may be cited as "Milton Keynes City Council (Various Roads, Milton Keynes) (Prohibition of Waiting) Order 2023".

2. In this Order, except where the context otherwise requires, the following expressions have the meanings respectively assigned to them:-

"access way" means a length of road sufficient to enable a vehicle to have access to and egress from land or premises in or adjacent to the road;

"Civil Enforcement Officer" ("CEO") has the same meaning as in Section 76 of the Traffic Management Act of 2004;

"Council" means Milton Keynes City Council;

"disabled persons' vehicle" has the same meaning as in the Local Authorities' Traffic Orders (Exemptions for Disabled Persons) (England) Regulations 2000;

"goods" includes postal packets of any description, cash or other valuable securities;

"delivering" and **"collecting"** in relation to any goods includes checking the goods for the purpose of their delivery or collection;

"goods vehicle" means a motor vehicle constructed or adapted for use for the carriage of goods, or a trailer so constructed or adapted and having a gross vehicle weight or an operating weight exceeding 5 tonnes;

"payment day" means the date by which payment should be made, as specified in the most recent notice received by the driver or owner of the vehicle;

"penalty charge" has the same meaning as in Section 66(2) of the Road Traffic Act 1991;

"penalty charge notice" means a notice dispensed by a parking attendant informing the driver of the vehicle that they are in contravention of a restriction and that a penalty charge is now owed;

"postal packets" has the same meaning as in Section 125 of the Postal Services Act 2000;

"road" means a highway and any other road to which the public has access;

"**statutory undertaker**" has the same meaning as in Section 329 of the Highways Act 1980;

"telecommunications apparatus" has the same meaning as in the Telecommunications Act 1984;

"**traffic sign**" means a sign of any size, colour and type prescribed or authorised under, or having effect as though prescribed or authorised under, Section 64 of the Act of 1984.

3. Any reference in this Order to any enactment shall be construed as a reference to that enactment as amended by any subsequent enactment.
4. The plans annexed to this Order identify the lengths of road subject to this Order, provided that where there is any inconsistency between the plans and the Schedules it is the wording of the Schedules which shall prevail.

PART 2

PROHIBITION AND RESTRICTION OF WAITING

5. No person shall except with the permission or under the direction of a police officer in uniform or a traffic warden cause or permit any vehicle to wait at any time in any of the lengths of road specified in Schedule 1 hereto.
6. Nothing in Articles 5 above shall render it a contravention of this Order to cause or permit a vehicle to wait in any of the lengths of road specified in Schedule 1 for so long as may be necessary:
 - (1) when the person in control of the vehicle is required by law to stop or is obliged to stop in order to avoid an accident or is prevented from proceeding by circumstances outside his control;
 - (2) for a vehicle to wait whilst any gate or other barrier at the entrance to premises to which the vehicle requires access or from which it has emerged is being opened or closed, if it is not reasonably practicable for the vehicle to wait outside otherwise than in a length of road specified in Schedule 1 to this Order while such gate or other barrier is being opened or closed;
 - (3) to enable a person to board or alight from the vehicle;
 - (4) to enable goods to be loaded or unloaded from the vehicle;
 - (5) to enable the vehicle if it cannot reasonably be used for such purpose in any other road to be used in connection with any of the following:
 - a) building, industrial or demolition operations;
 - b) the removal of any obstruction to traffic;

- c) the laying, erection or repair of any sewer, main, pipe or apparatus for the supply of gas, water, electricity or any telecommunication system defined by the Telecommunications Act 1984;
 - d) use in the service of any undertaker, the Environment Agency or any public authority in pursuance of statutory powers or duties;
 - e) in connection with any wedding or funeral;
 - f) use for police, fire brigade or ambulance purposes;
 - g) use for the purpose of delivering or collecting postal packets as defined by section 125 of the Postal Services Act 2000;
 - h) the vehicle, being a bus, to wait in a bus stop area;
 - i) the vehicle being specially constructed or adapted for the delivery or collection of money or valuable securities to be used for those purposes in relation to premises in the vicinity.
7. In accordance with the Local Authorities' Traffic Orders (Exemptions for Disabled Persons) (England) Regulations 2000, nothing in Article 5 shall render it unlawful to cause or permit a disabled person's vehicle which displays a disabled person's badge and parking disc in the relevant position in accordance with Article 6 hereof to wait for a period not exceeding 3 hours in a length of road specified in Schedule 1 hereto (provided the period of exempted waiting does not begin less than one hour after a previous period of exempted waiting by the same vehicle in the same road on the same day).
8. For the purposes of this Order a vehicle shall be regarded as displaying a disabled person's badge in the relevant position under the Disabled Persons (Badges for Motor Vehicles) (England) Regulations 2000 if:
- (1) the badge is exhibited on the dashboard or fascia of the vehicle so that the front of the badge is clearly legible from the outside of the vehicle; or
 - (2) where the vehicle is not fitted with a dashboard or fascia, the badge is exhibited in a conspicuous position on the vehicle so that the front of the badge is clearly legible from the outside of the vehicle.

PART 3

ENFORCEMENT OF RESTRICTIONS

9. The Council shall, on or in the vicinity of a restricted road:
- (1) Highlight each restricted area with notices, signs and road surface markings in accordance with the Traffic Signs Regulations and General Directions Act 1994;
 - (2) Maintain and from time to time alter the said notices, signs and road-surface markings;

- (3) Carry out such other work as is reasonably required for the purpose of the satisfactory operation of a restricted road.
10. The Council shall appoint Civil Enforcement Officers (CEOs) whose duty it shall be to patrol and enforce the waiting and parking restrictions imposed by the articles of this Order.

SCHEDULE 1

NO WAITING AT ANY TIME

BUCKLAND DRIVE, NETHERFIELD BOTH SIDES

NW1 From a point 14.4 metres south-west of its junction with Marlborough Street, for a distance of 27.5 metres in a south-westerly direction

FEN STREET, MAGNA PARK THE NORTHBOUND CARRIAGEWAY BOTH SIDES

NW2 From a point 43 metres south of its junction with Crossley Drive, for a distance of 28.5 metres in a southerly direction

FEN STREET, MAGNA PARK THE SOUTHBOUND CARRIAGEWAY BOTH SIDES

NW3 From a point 43 metres south of its junction with Crossley Drive, for a distance of 28.5 metres in a southerly direction

LEOPARD DRIVE, GREAT LINFORD BOTH SIDES

NW4 From a point 40.3 metres south-west of its junction with the centreline of Florin Close, for a distance of 20 metres in a south-westerly direction

LEOPARD DRIVE, GREAT LINFORD BOTH SIDES

NW5 From a point 36 metres north-west of its junction with the centreline of Carolus Creek, for a distance of 19.3 metres in a north-westerly direction

LLOYDS, COFFEE HALL BOTH SIDES

NW6 From a point 69 metres west of its junction with the centreline of Rochfords, for a distance of 20.2 metres in a westerly direction

MAIDSTONE ROAD, KINGSTON BOTH SIDES

NW7 From its junction with Mandeville Drive, for a distance of 30.5 metres in an easterly direction

MICHIGAN DRIVE, TONGWELL BOTH SIDES

NW8 From its junction with Delaware Drive, for a distance of 30.5 metres in a north-easterly direction

SOVEREIGN DRIVE, GREAT LINFORD

BOTH SIDES

NW9 From a point 44 metres south-east of its junction with the centreline of Leopard Drive, for a distance of 20.4 metres in a south-easterly direction

SUTCLIFFE AVENUE, OLDBROOK

SOUTH-WEST SIDE

NW10 From a point in line with the south-eastern boundary line of number 1 Sutcliffe Avenue, for a distance of 3.5 metres in a south-easterly direction

SUTCLIFFE AVENUE, OLDBROOK

NORTH-EAST SIDE

NW11 From a point in line with the south-westerly boundary line of number 10 Sutcliffe Avenue, for a distance of 3.5 metres in a south-easterly direction

SUTCLIFFE AVENUE, OLDBROOK

SOUTH-WEST SIDE

NW12 From a point in line with the south-eastern boundary line of number 17 Sutcliffe Avenue, for a distance of 3.5 metres in a south-easterly direction

SUTCLIFFE AVENUE, OLDBROOK

NORTH-EAST SIDE

NW13 From a point in line with the south-westerly boundary line of number 26 Sutcliffe Avenue, for a distance of 3.5 metres in a south-easterly direction

SUTCLIFFE AVENUE, OLDBROOK

SOUTH-WEST SIDE

NW14 From a point in line with the south-eastern boundary line of number 33 Sutcliffe Avenue, for a distance of 3.5 metres in a south-easterly direction

SUTCLIFFE AVENUE, OLDBROOK

NORTH-EAST SIDE

NW15 From a point in line with the south-westerly boundary line of number 42 Sutcliffe Avenue, for a distance of 3.5 metres in a south-easterly direction

SWANWICK LANE, BROUGHTON

BOTH SIDES

NW16 From a point 21.5 metres north-west of its junction with the centreline of Staverton Grove and Ulverston Crescent, for a distance of 29.1 metres in a north-westerly direction

TANNERS DRIVE, BLAKELANDS

BOTH SIDES

NW17 From a point 21.3 metres north-east of its junction with Brickhill Street, for a distance of 27.5 metres in a north-easterly direction

WEDGWOOD AVENUE, BLAKELANDS

BOTH SIDES

NW18 From a point 32.8 metres west of its junction with Smeaton Close, for a distance of 15.5 metres in a south-westerly direction

WINCHESTER CIRCLE, KINGSTON

SOUTH-EAST SIDE

NW19 From a point 17 metres north-east of its junction with Mandeville Drive, for a distance of 29 metres in a north-easterly direction

YEOMANS DRIVE, BLAKELANDS

BOTH SIDES

NW20 From its junction with Brickhill Street, for a distance of 45 metres in a north-easterly direction

--- END ---

**THE COMMON SEAL OF the MILTON
KEYNES CITY COUNCIL** was hereunto
affixed this day of 2023 in the
presence of:-

.....
HEAD OF LEGAL SERVICES

MAP 1 FOR ORDER

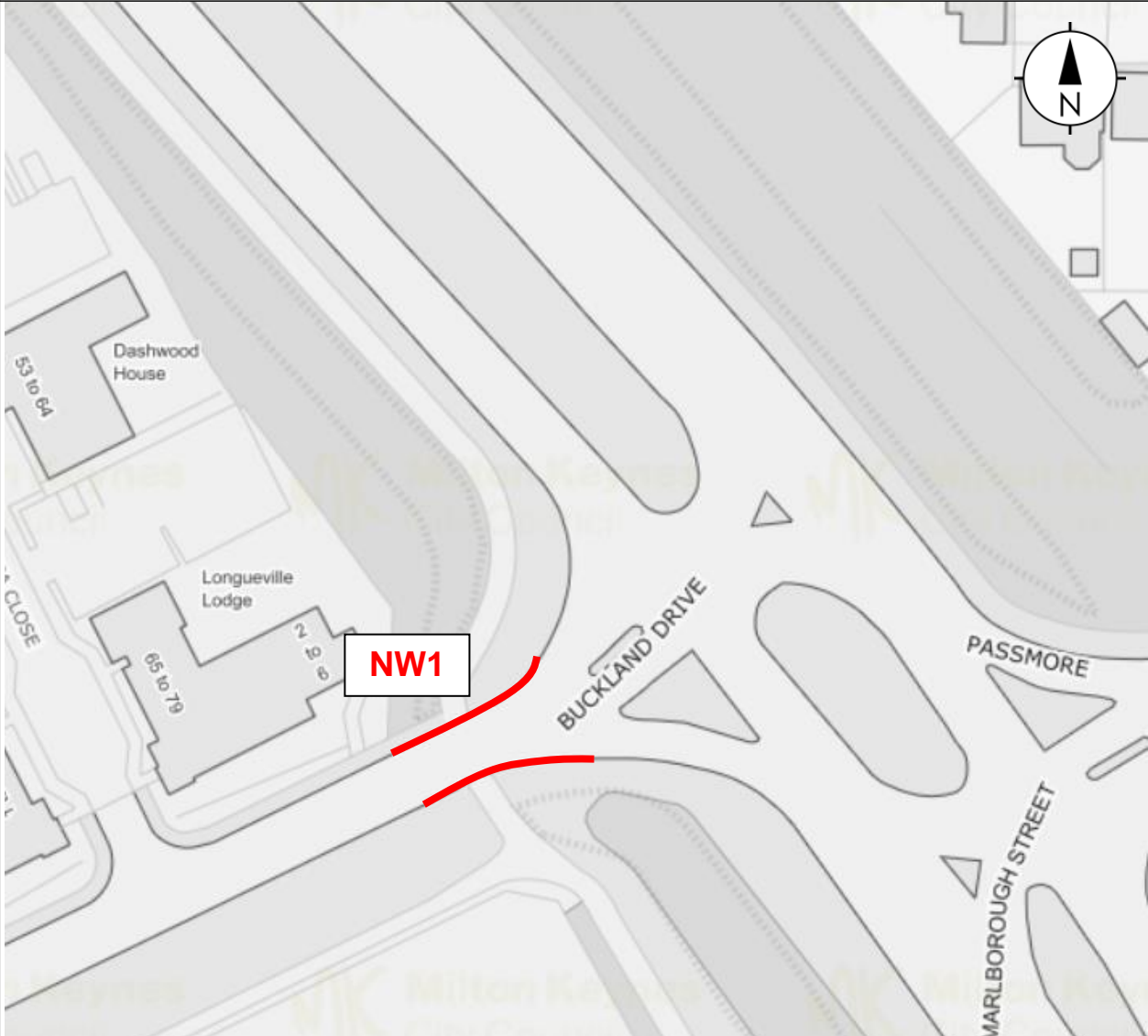

-  No waiting at any time restriction
- NW1** Schedule 1 reference number

Map referred to in “Milton Keynes City Council (Various Roads, Milton Keynes) (Prohibition of Waiting) Order 2023”

This Map not to scale

The Common Seal of Milton Keynes City Council was hereunto affixed in the presence of:

.....
Head of Legal Services

MAP 2 FOR ORDER

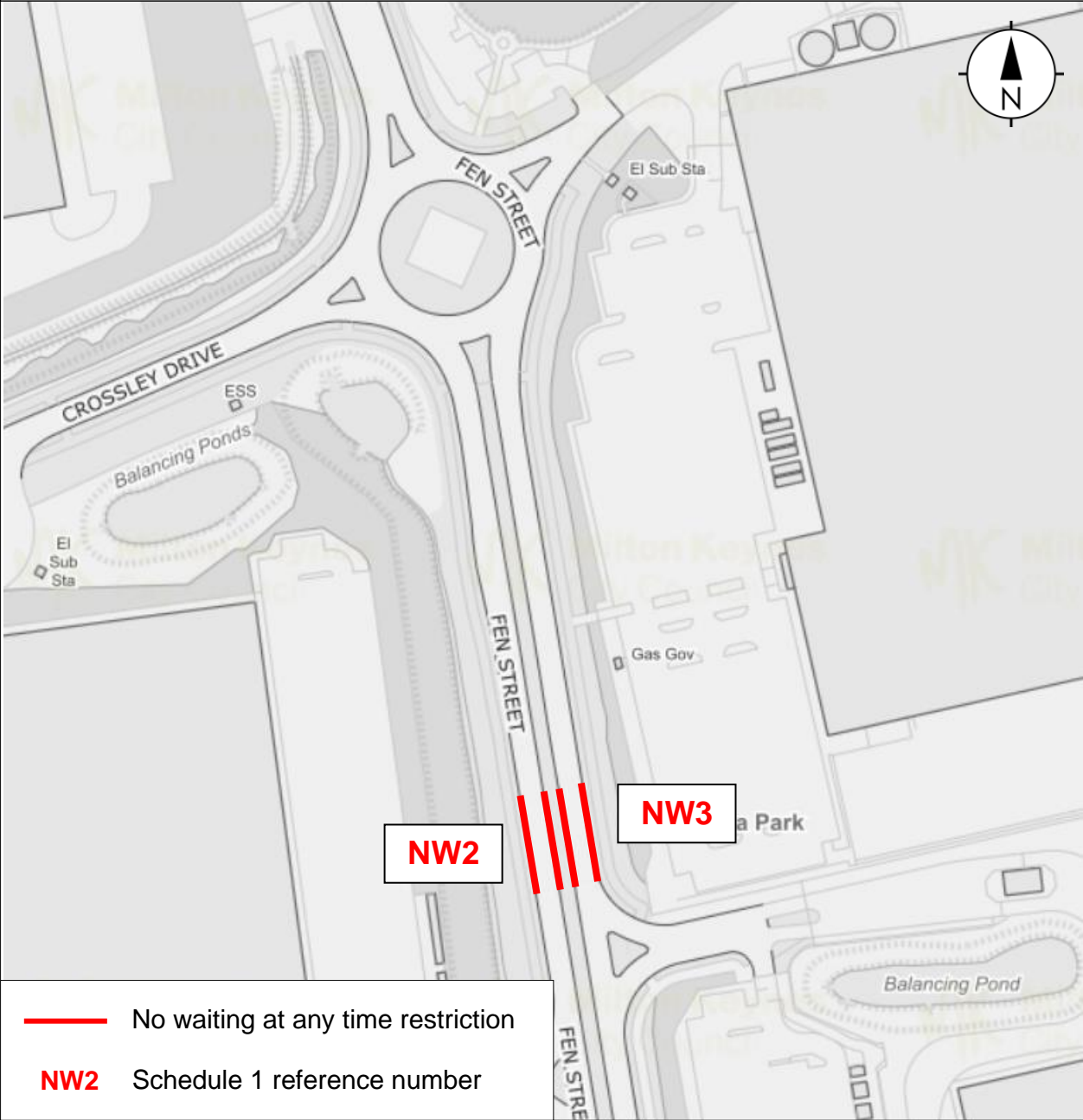

— No waiting at any time restriction

NW2 Schedule 1 reference number

Map referred to in “Milton Keynes City Council (Various Roads, Milton Keynes) (Prohibition of Waiting) Order 2023”

This Map not to scale

The Common Seal of Milton Keynes City Council was hereunto affixed in the presence of:

.....
Head of Legal Services

MAP 3 FOR ORDER

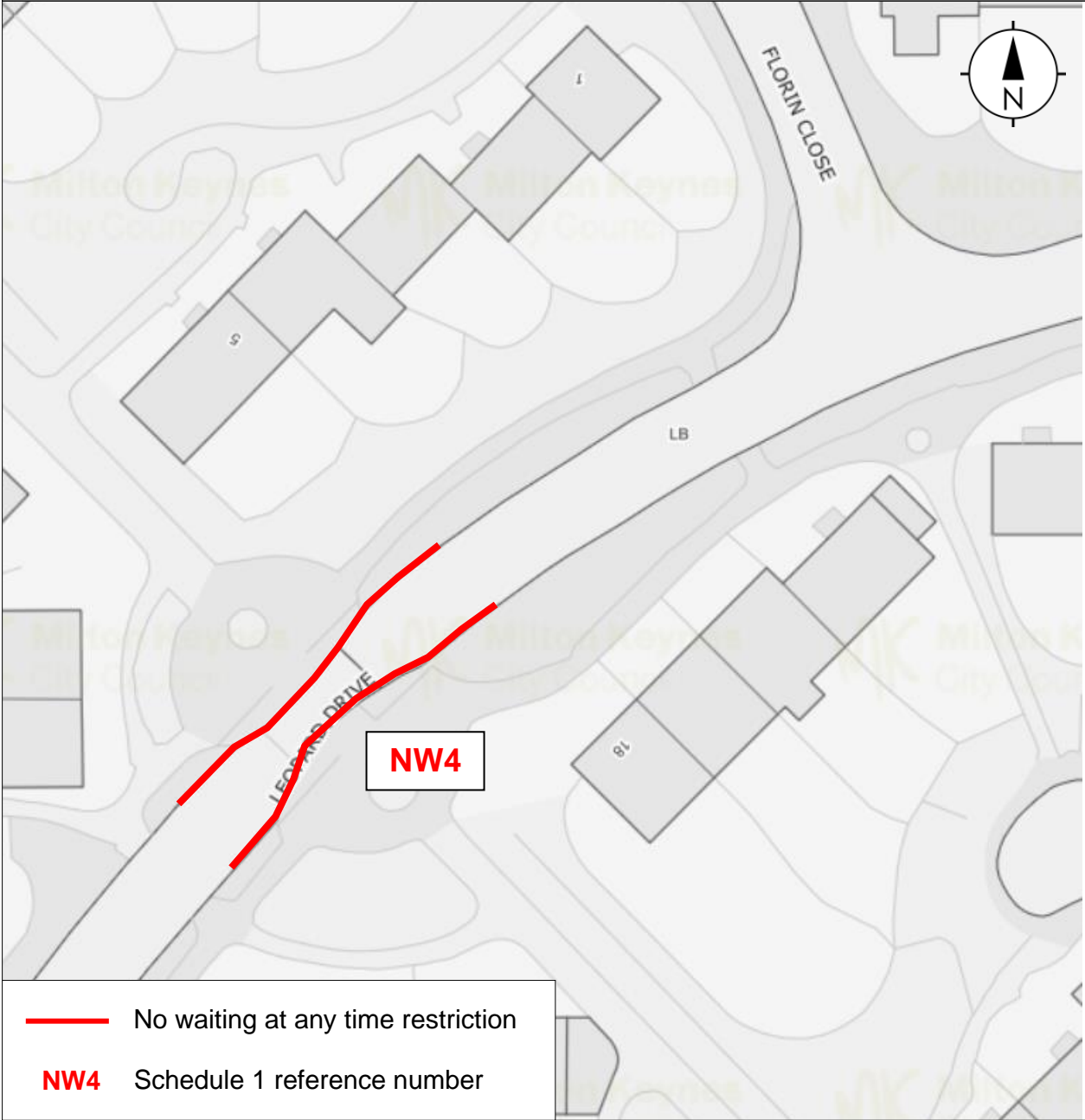

Map referred to in “Milton Keynes City Council (Various Roads, Milton Keynes) (Prohibition of Waiting) Order 2023”

This Map not to scale

The Common Seal of Milton Keynes City Council was hereunto affixed in the presence of:

.....
Head of Legal Services

MAP 4 FOR ORDER

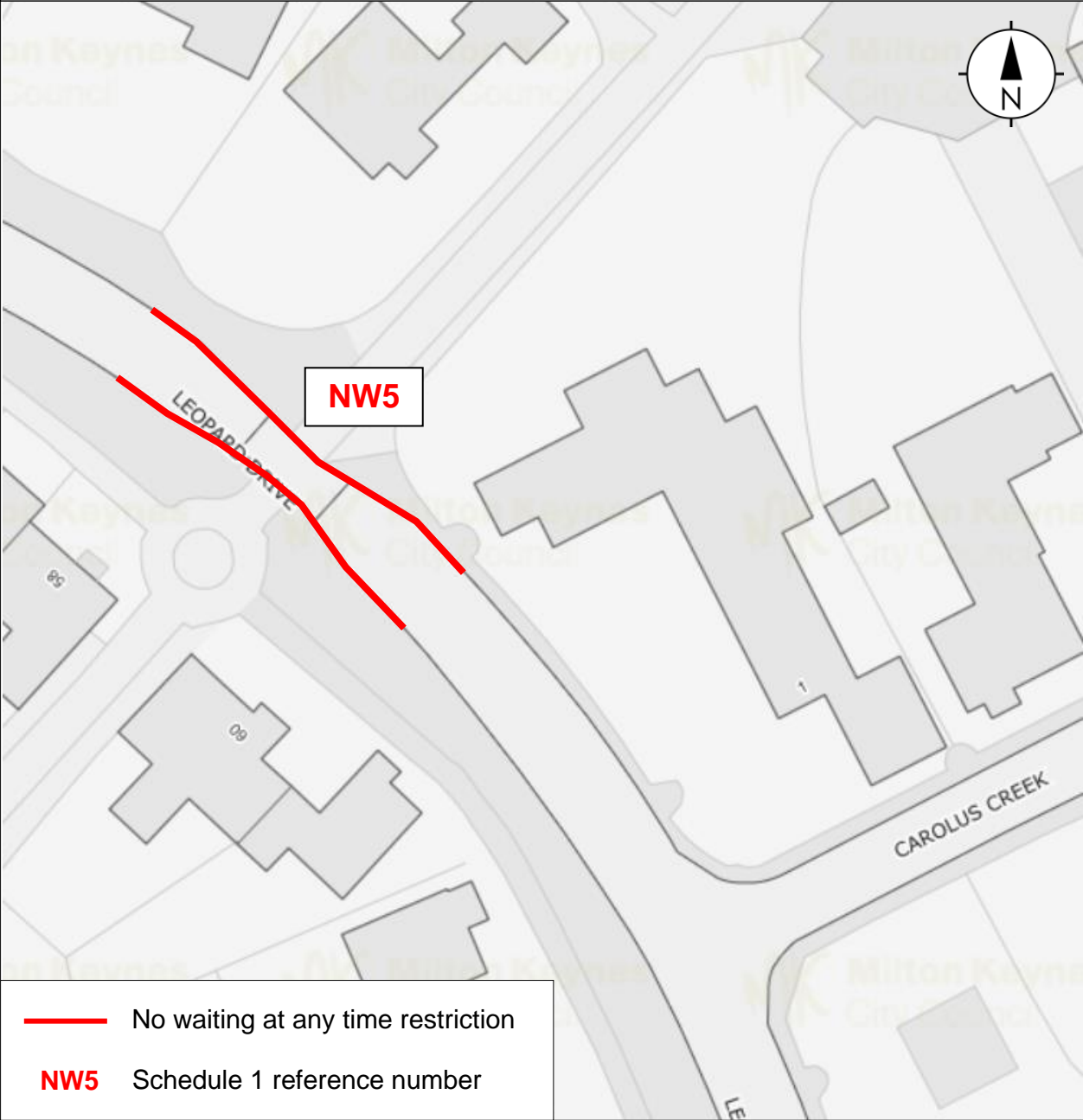

Map referred to in “Milton Keynes City Council (Various Roads, Milton Keynes) (Prohibition of Waiting) Order 2023”

This Map not to scale

The Common Seal of Milton Keynes City Council was hereunto affixed in the presence of:

.....
Head of Legal Services

MAP 5 FOR ORDER

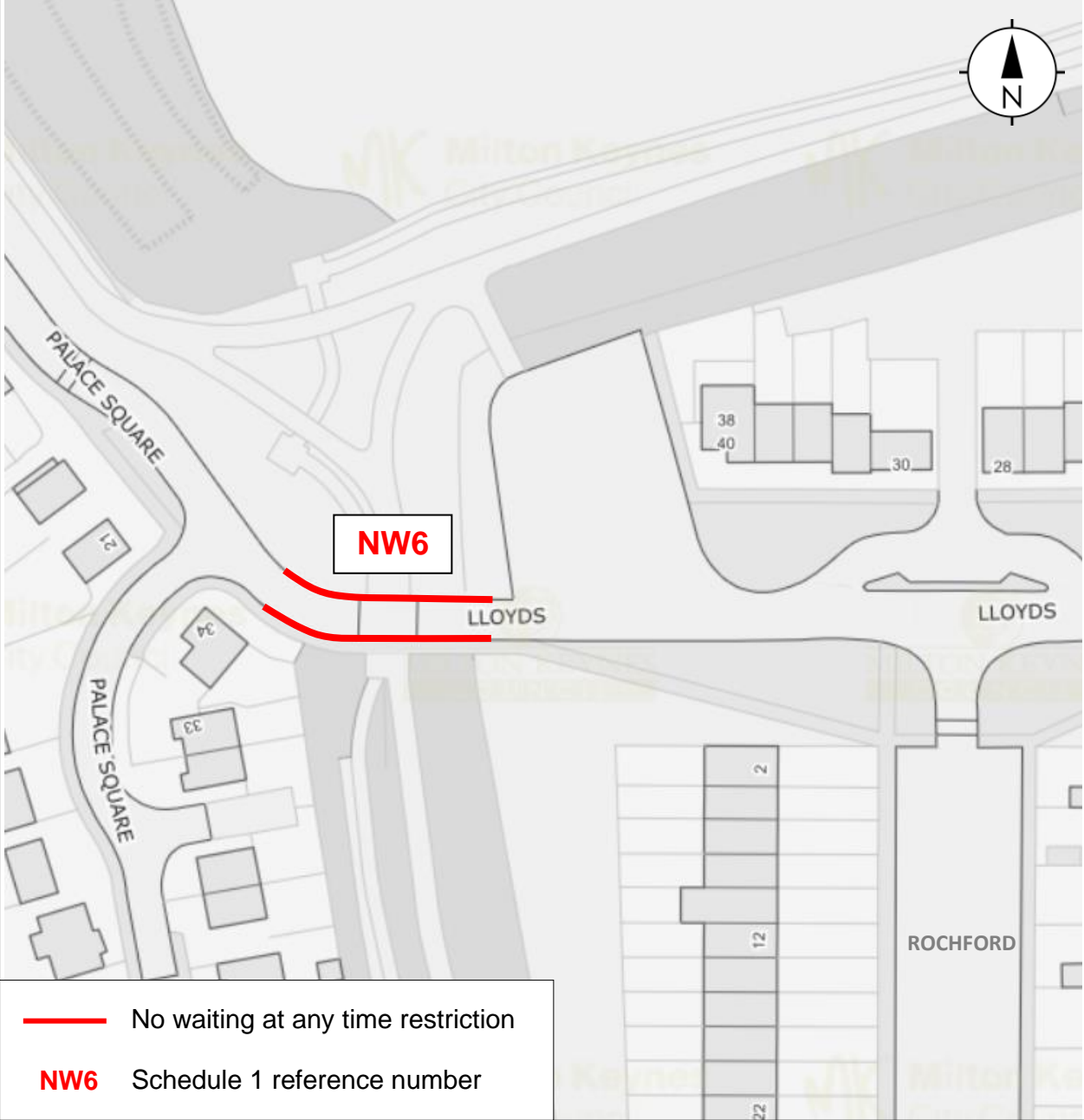

Map referred to in “Milton Keynes City Council (Various Roads, Milton Keynes) (Prohibition of Waiting) Order 2023”

This Map not to scale

The Common Seal of Milton Keynes City Council was hereunto affixed in the presence of:

.....
Head of Legal Services

MAP 6 FOR ORDER

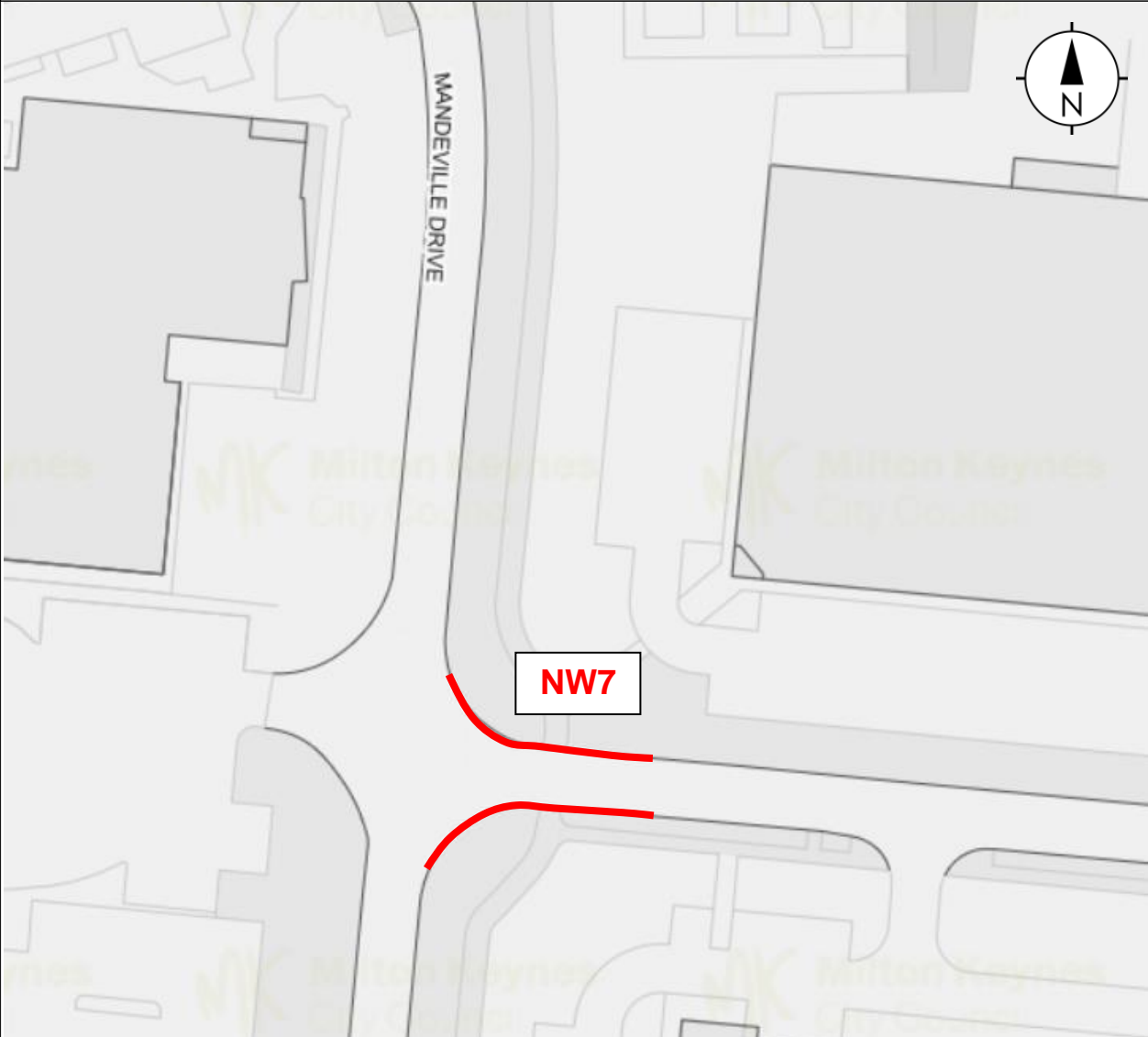

-  No waiting at any time restriction
- NW7** Schedule 1 reference number

Map referred to in “Milton Keynes City Council (Various Roads, Milton Keynes) (Prohibition of Waiting) Order 2023”

This Map not to scale

The Common Seal of Milton Keynes City Council was hereunto affixed in the presence of:

.....
Head of Legal Services

MAP 7 FOR ORDER

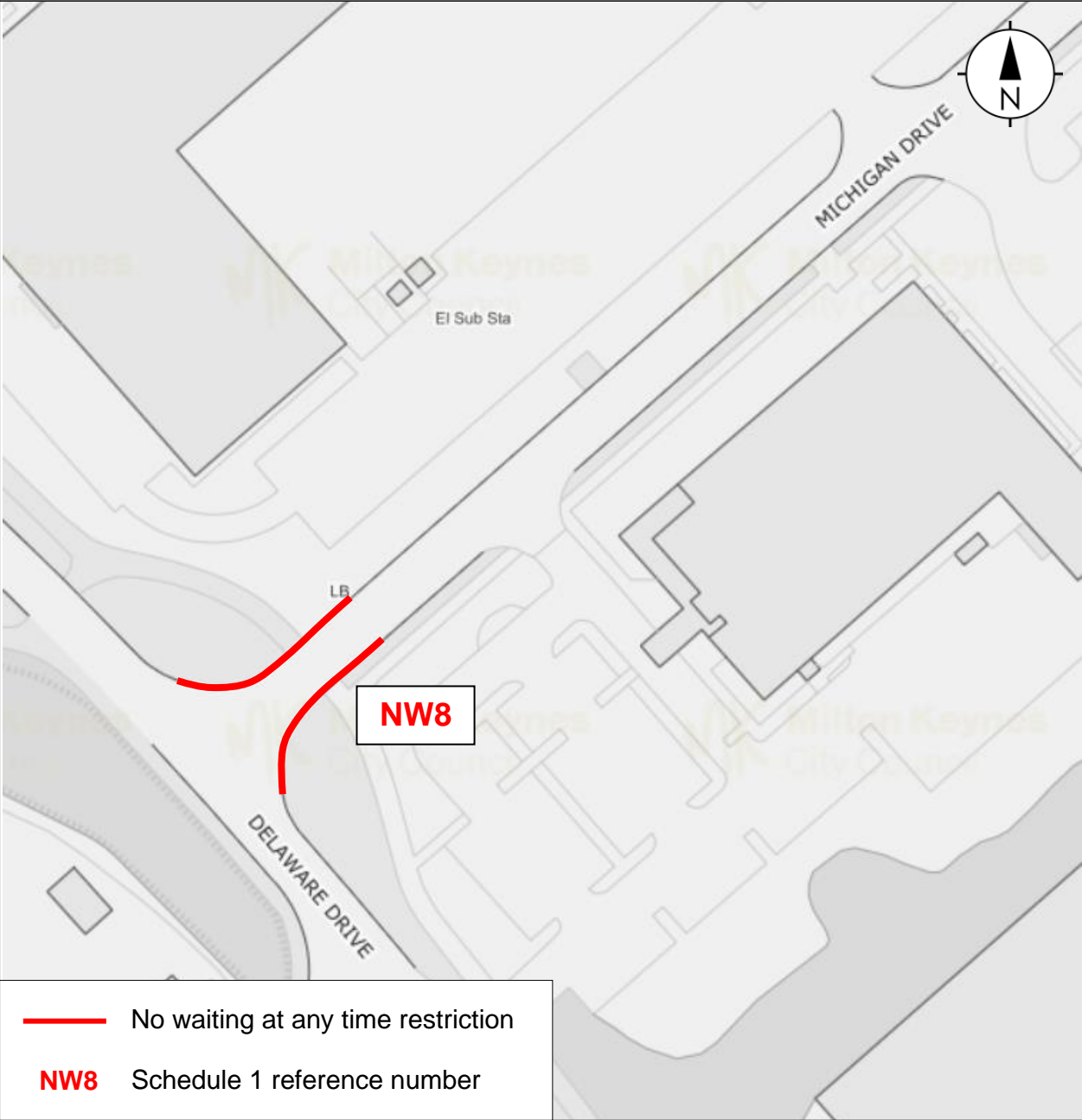

Map referred to in "Milton Keynes City Council (Various Roads, Milton Keynes) (Prohibition of Waiting) Order 2023"

This Map not to scale

The Common Seal of Milton Keynes City Council was hereunto affixed in the presence of:

.....
Head of Legal Services

MAP 8 FOR ORDER

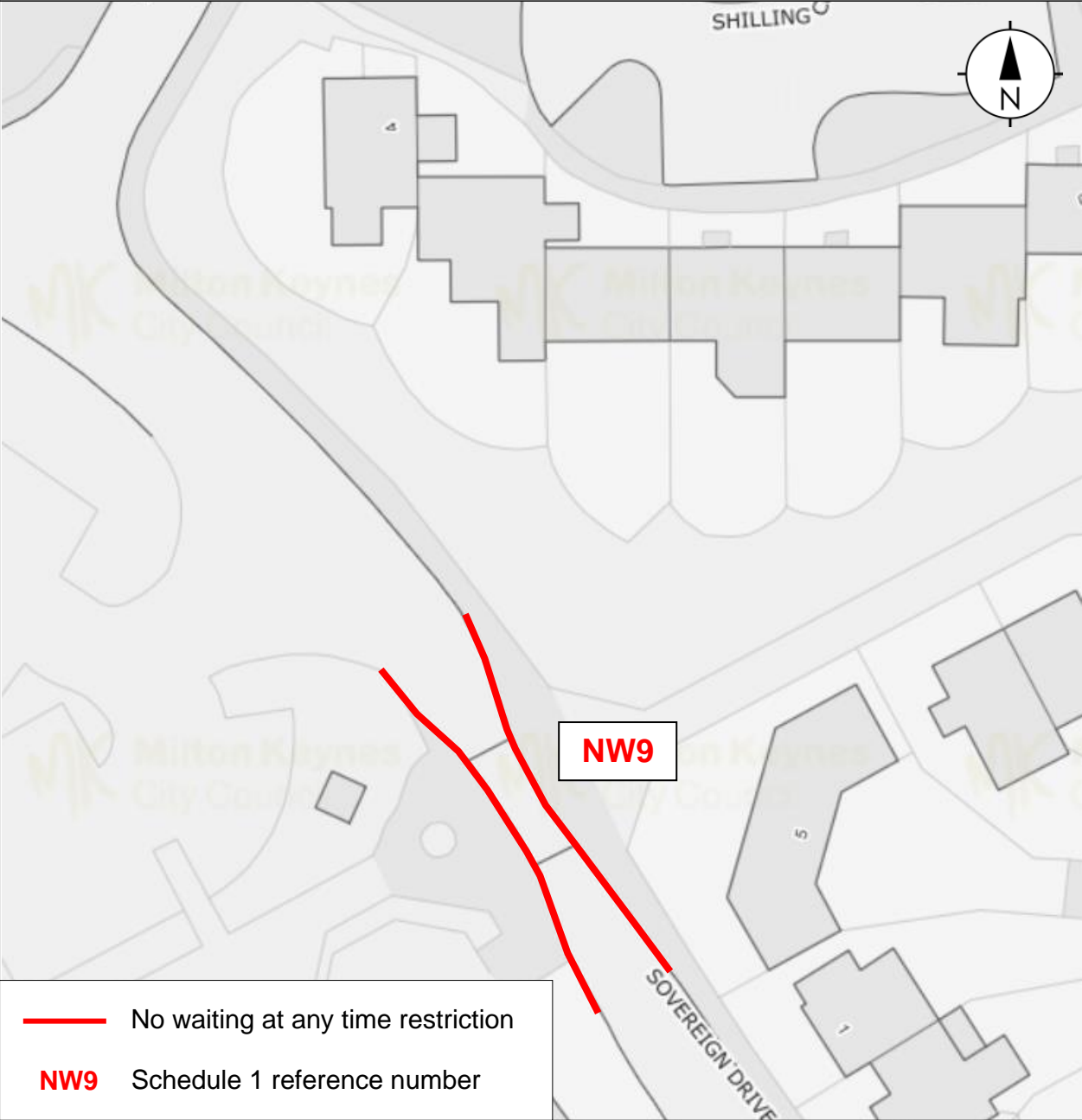

Map referred to in “Milton Keynes City Council (Various Roads, Milton Keynes) (Prohibition of Waiting) Order 2023”

This Map not to scale

The Common Seal of Milton Keynes City Council was hereunto affixed in the presence of:

.....
Head of Legal Services

MAP 9 FOR ORDER

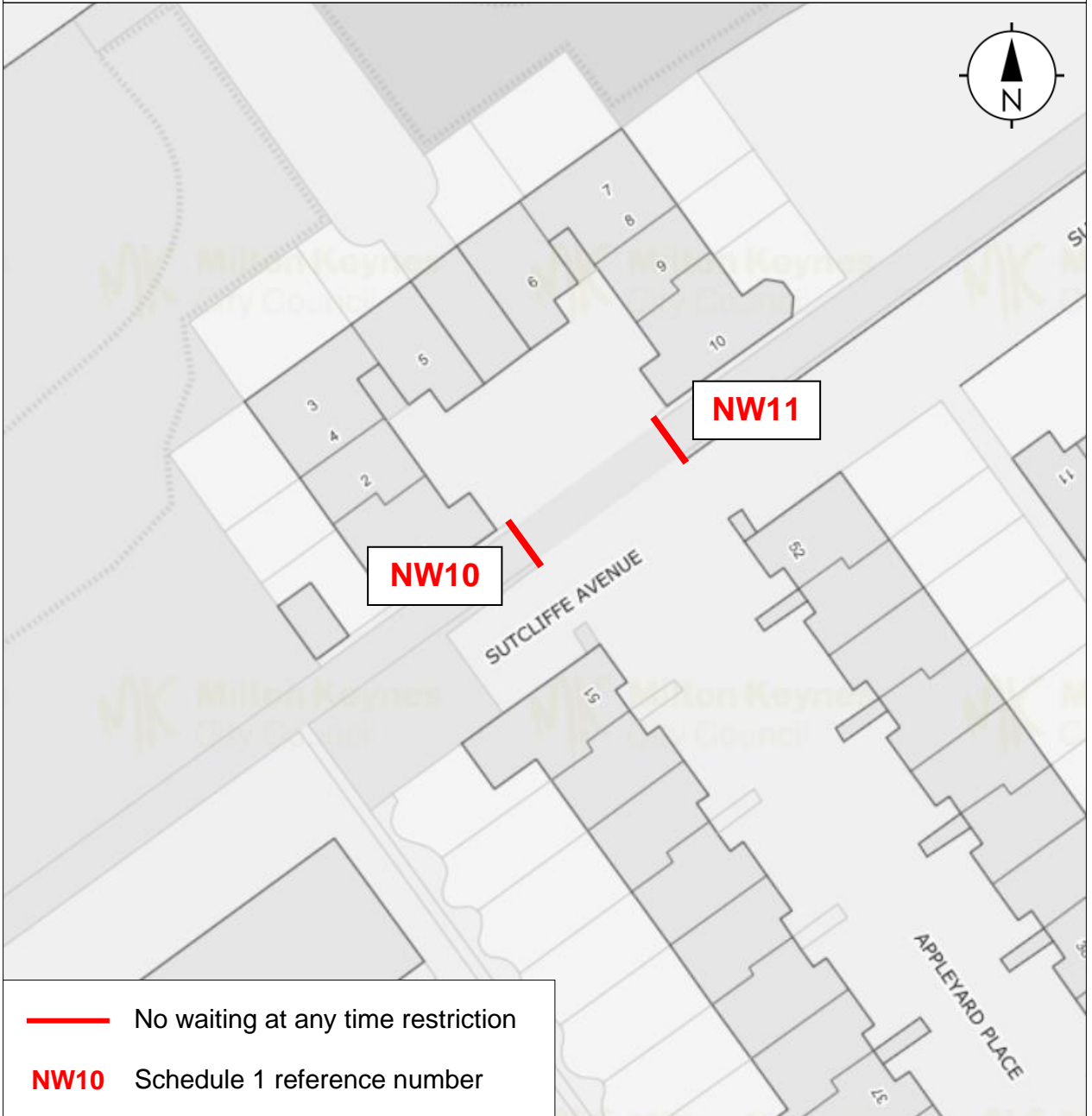

Map referred to in "Milton Keynes City Council (Various Roads, Milton Keynes) (Prohibition of Waiting) Order 2023"

This Map not to scale

The Common Seal of Milton Keynes City Council was hereunto affixed in the presence of:

.....
Head of Legal Services

MAP 10 FOR ORDER

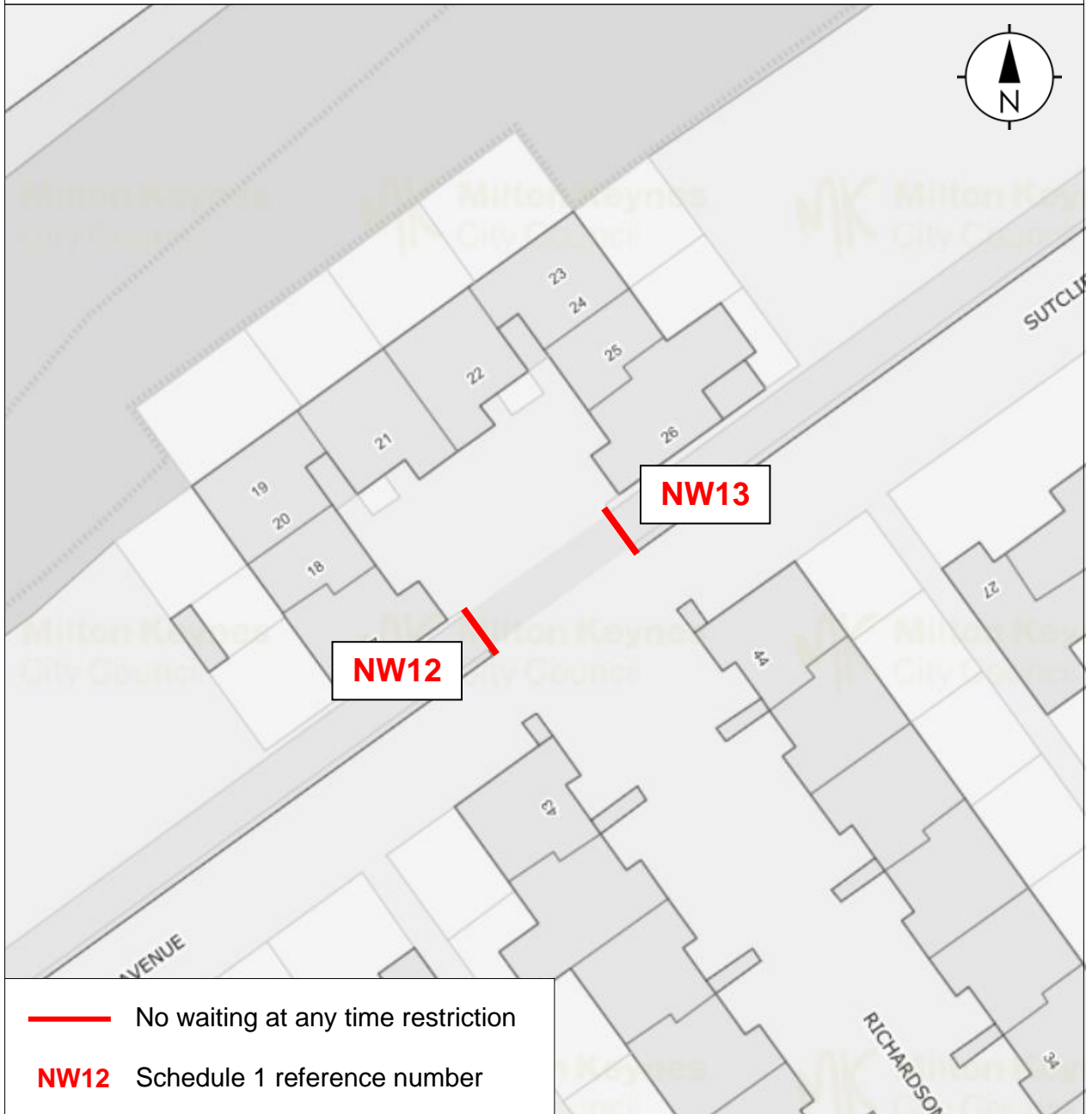

Map referred to in "Milton Keynes City Council (Various Roads, Milton Keynes) (Prohibition of Waiting) Order 2023"

This Map not to scale

The Common Seal of Milton Keynes City Council was hereunto affixed in the presence of:

.....
Head of Legal Services

MAP 11 FOR ORDER

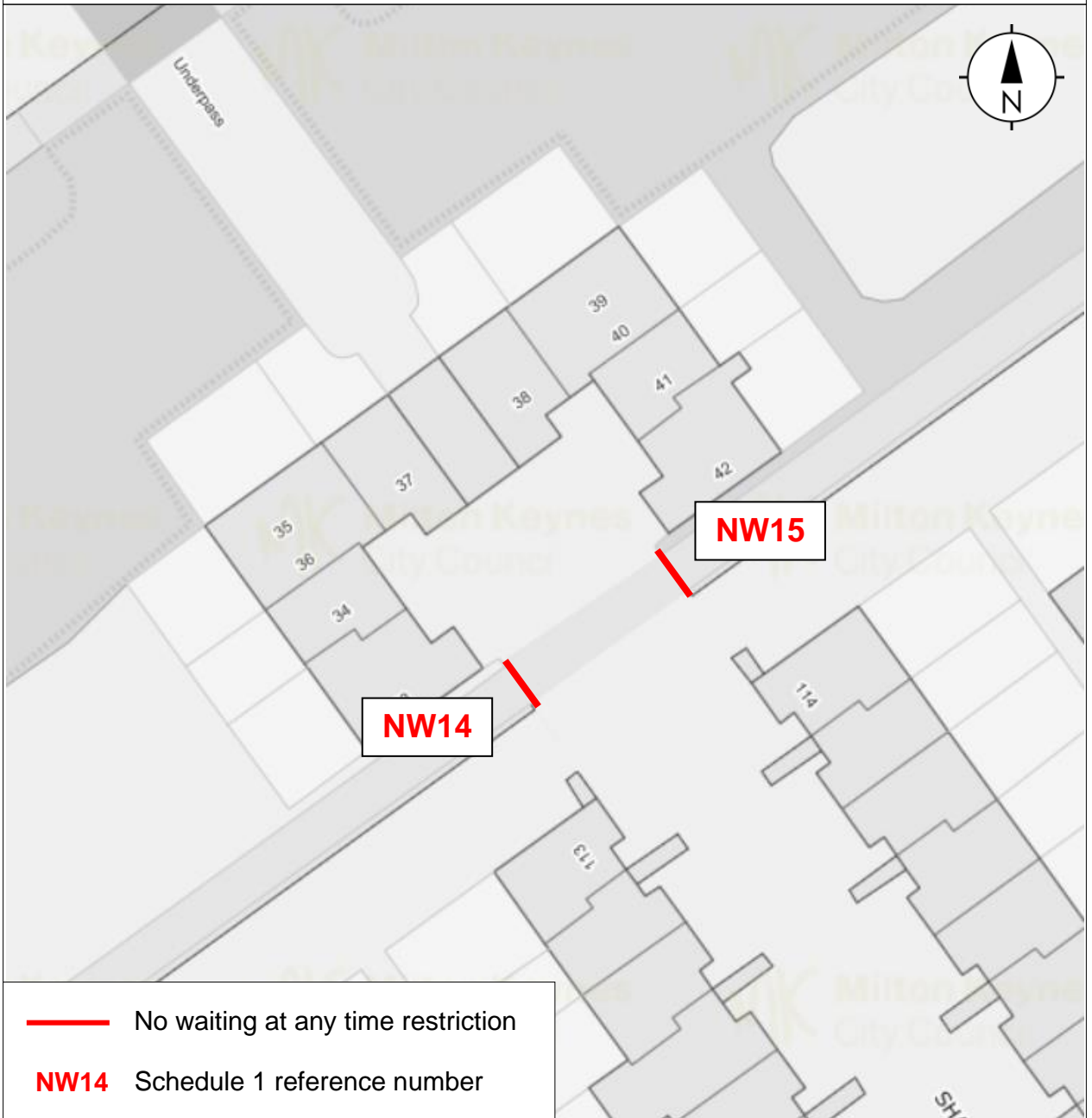

— No waiting at any time restriction

NW14 Schedule 1 reference number

Map referred to in "Milton Keynes City Council (Various Roads, Milton Keynes) (Prohibition of Waiting) Order 2023"

This Map not to scale

The Common Seal of Milton Keynes City Council was hereunto affixed in the presence of:

.....
Head of Legal Services

MAP 12 FOR ORDER

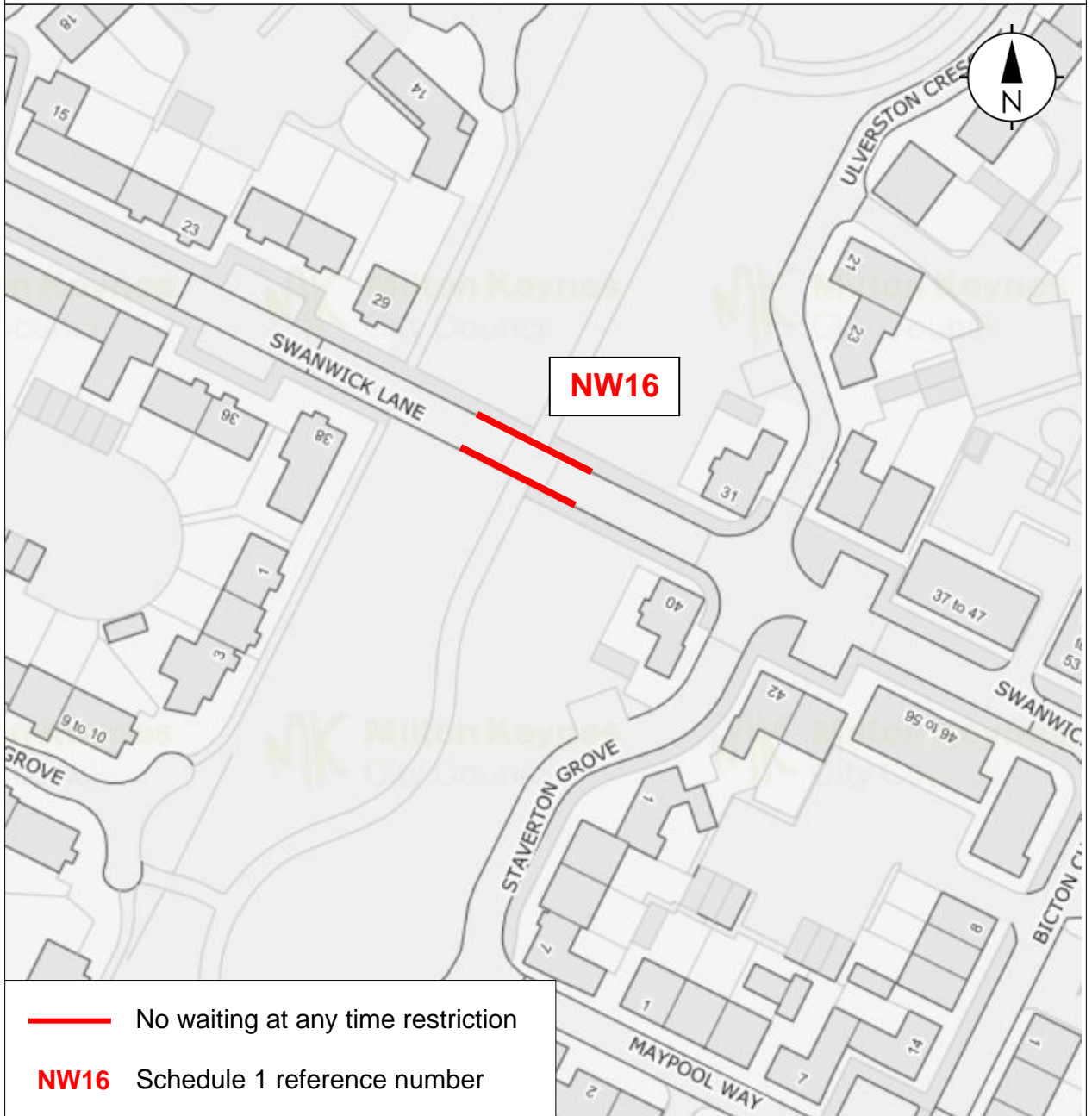

Map referred to in "Milton Keynes City Council (Various Roads, Milton Keynes) (Prohibition of Waiting) Order 2023"

This Map not to scale

The Common Seal of Milton Keynes City Council was hereunto affixed in the presence of:

.....
Head of Legal Services

MAP 13 FOR ORDER

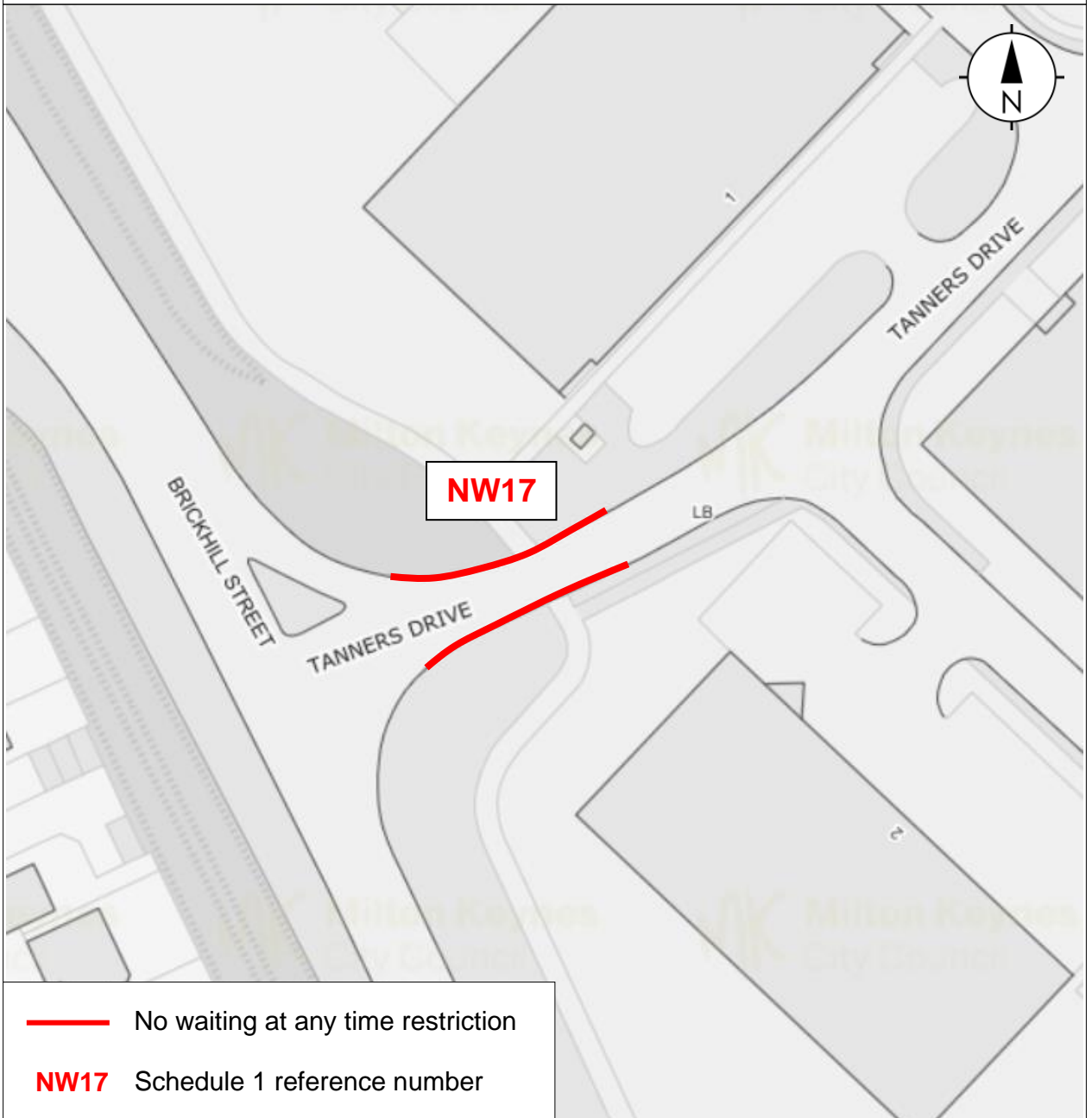

Map referred to in "Milton Keynes City Council (Various Roads, Milton Keynes) (Prohibition of Waiting) Order 2023"

This Map not to scale

The Common Seal of Milton Keynes City Council was hereunto affixed in the presence of:

.....
Head of Legal Services

MAP 14 FOR ORDER

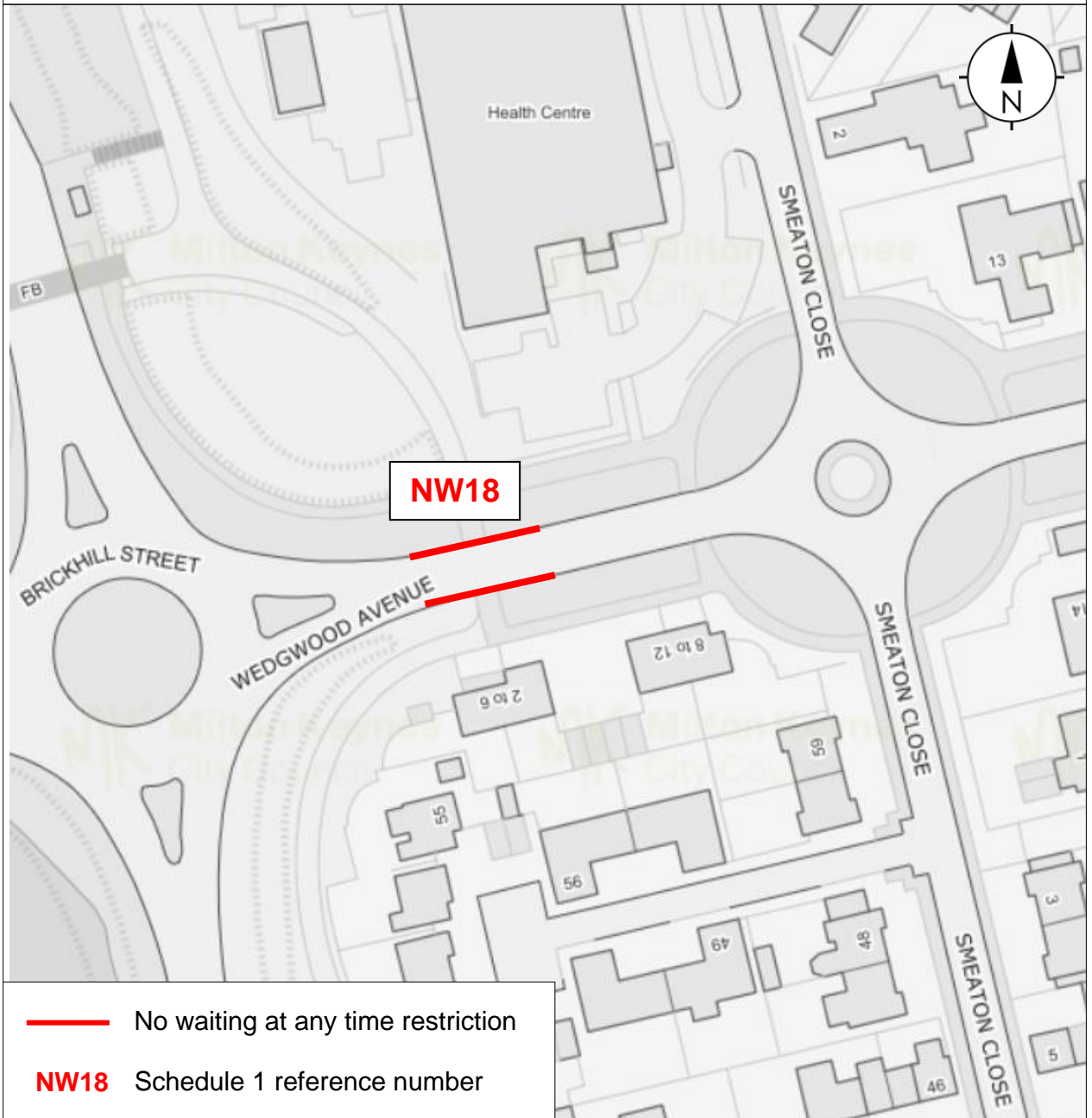

— No waiting at any time restriction

NW18 Schedule 1 reference number

Map referred to in "Milton Keynes City Council (Various Roads, Milton Keynes) (Prohibition of Waiting) Order 2023"

This Map not to scale

The Common Seal of Milton Keynes City Council was hereunto affixed in the presence of:

.....
Head of Legal Services

MAP 15 FOR ORDER

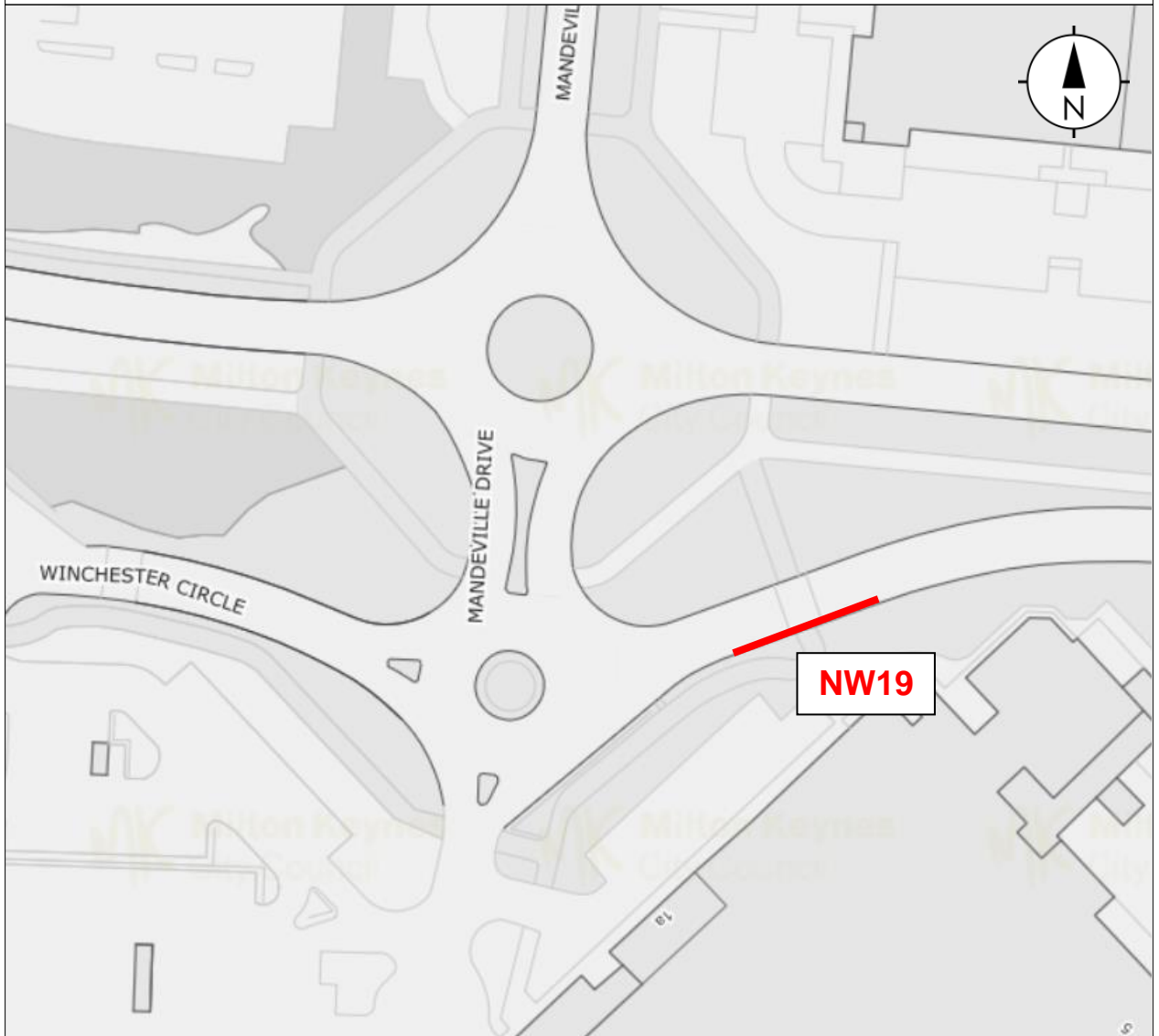

— No waiting at any time restriction

NW19 Schedule 1 reference number

Map referred to in "Milton Keynes City Council (Various Roads, Milton Keynes) (Prohibition of Waiting) Order 2023"

This Map not to scale

The Common Seal of Milton Keynes City Council was hereunto affixed in the presence of:

.....
Head of Legal Services

MAP 16 FOR ORDER

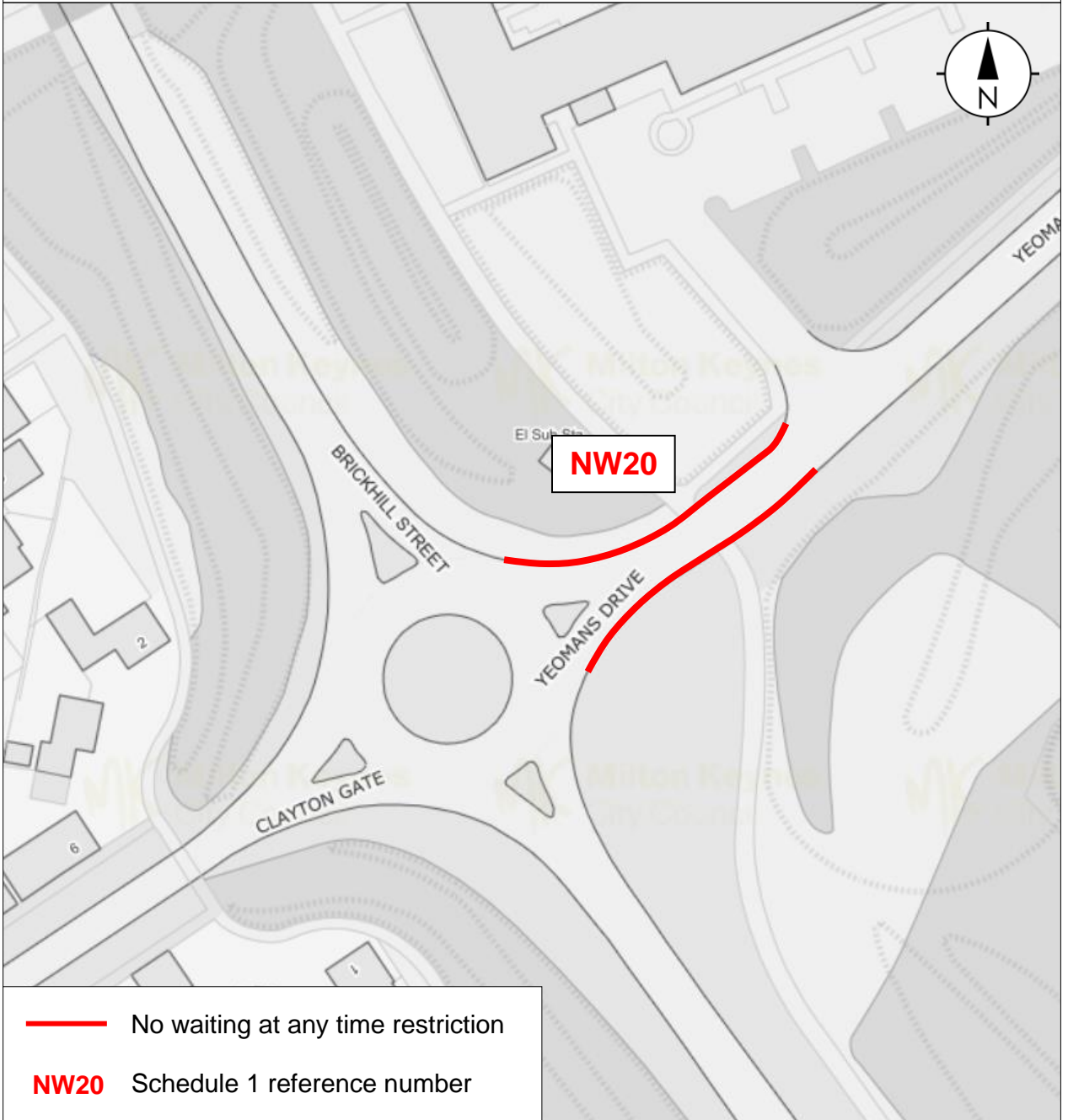

— No waiting at any time restriction

NW20 Schedule 1 reference number

Map referred to in "Milton Keynes City Council (Various Roads, Milton Keynes) (Prohibition of Waiting) Order 2023"

This Map not to scale

The Common Seal of Milton Keynes City Council was hereunto affixed in the presence of:

.....
Head of Legal Services