

EXAMPLE OF TYPICAL SECTION THROUGH A 5m SEGREGATED REDWAY

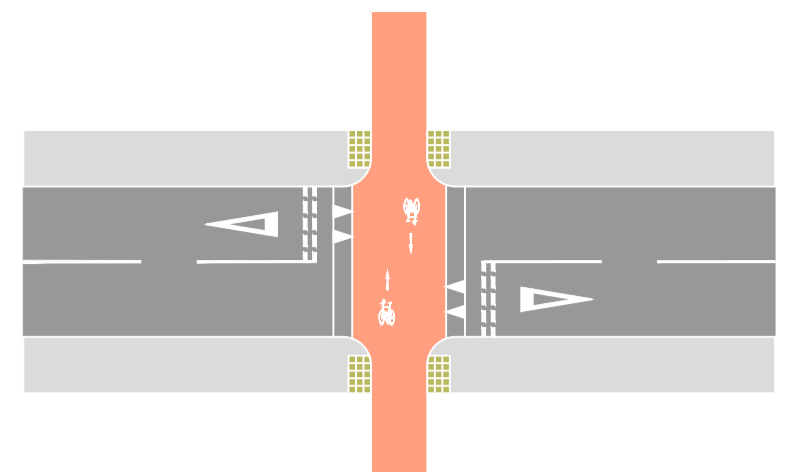

EXAMPLE OF A CYCLE PRIORITY CROSSING AS FIGURE 10.6 OF LTN 1/20

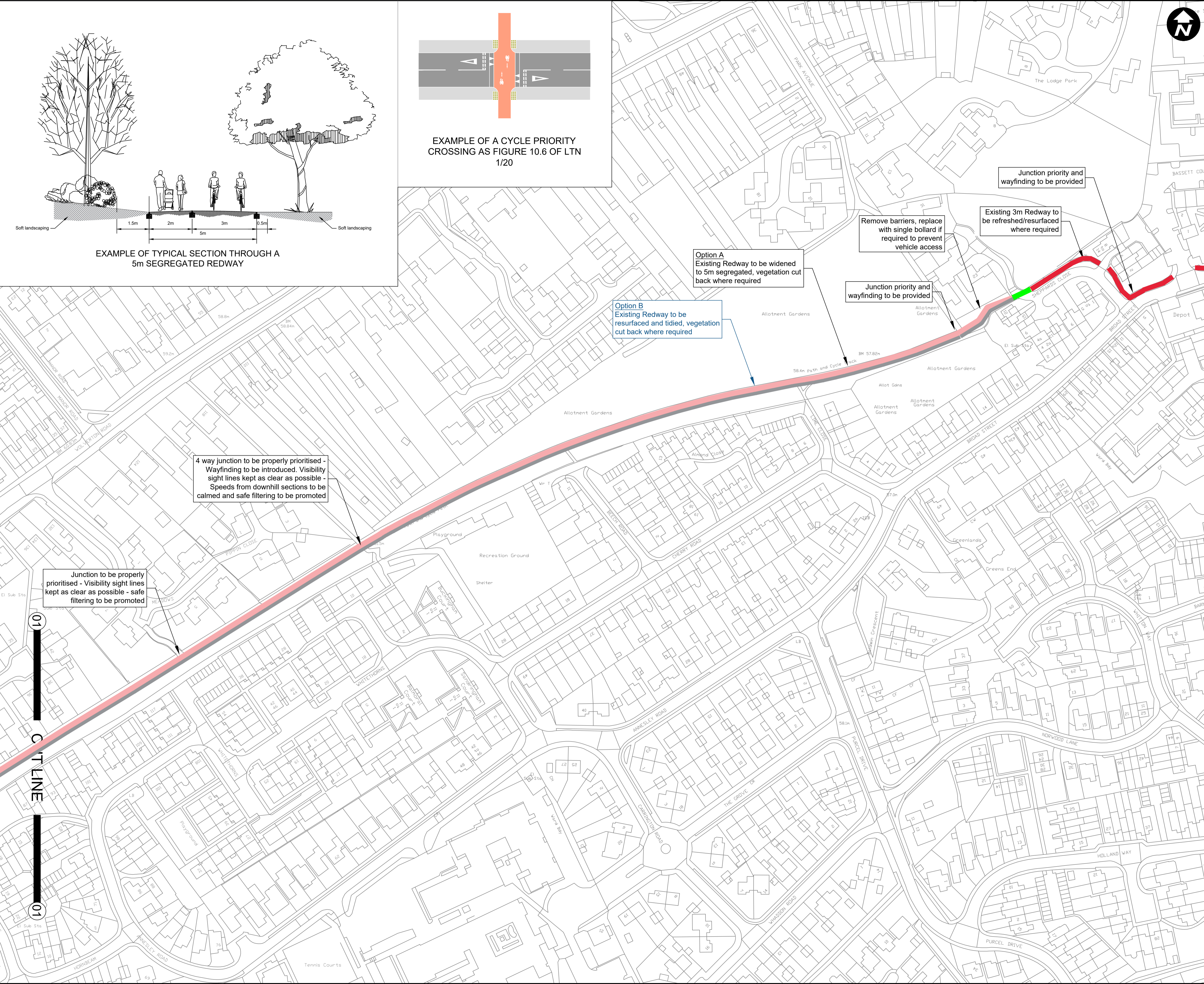

- GENERAL NOTES
- G1. DO NOT SCALE THIS DRAWING.
  - G2. ANY DIMENSIONAL DISCREPANCIES SHOULD BE NOTIFIED TO THE ENGINEER IMMEDIATELY.
  - G3. ALL DIMENSIONS ARE IN MILLIMETRES - (mm)
  - G4. ALL LEVELS ARE IN METRES - (m) AND ARE ABOVE ORDNANCE DATUM AT NEWLYN, CORNWALL UNLESS NOTED OTHERWISE.
  - G5. NORTH SHOWN INDICATIVE ONLY
  - G6. THIS DRAWING IS TO BE READ IN CONJUNCTION WITH ALL RELEVANT SPECIFICATIONS, DRAWINGS, DETAILS AND OTHER DESIGN INFORMATION.
  - G7. ALL DRAWINGS AND WRITTEN MATERIAL CONTAINED WITHIN, CONSTITUTE ORIGINAL AND UNPUBLISHED WORK OF THE ENGINEER AND MAY NOT BE DUPLICATED, USED, REPRODUCED OR DISCLOSED WITHOUT WRITTEN CONSENT OR EXPRESS PERMISSION FROM THE ENGINEER.
  - G8. WHERE THE CONTRACTOR UNDERTAKES OR ENGAGES A THIRD PARTY TO UNDERTAKE TEMPORARY WORKS DESIGN, OR VARIES THE PELL FRISCHMANN DESIGN IN ANY WAY, THEN THE CONTRACTOR WILL TAKE FULL RESPONSIBILITY AND LIABILITY FOR ALL DESIGN ASPECTS, INCLUDING A DESIGN RISK ASSESSMENT. THE CONTRACTOR SHALL INFORM PELL FRISCHMANN OF ANY PROPOSED VARIANCES TO THE DESIGN.

- KEY:
- 5m Segregated Pathway
  - Crossing point
  - Existing redway

# OPTION A Sheet 2

4 way junction to be properly prioritised - Wayfinding to be introduced. Visibility sight lines kept as clear as possible - Speeds from downhill sections to be calmed and safe filtering to be promoted

Junction to be properly prioritised - Visibility sight lines kept as clear as possible - safe filtering to be promoted

Option A Existing Redway to be widened to 5m segregated, vegetation cut back where required

Option B Existing Redway to be resurfaced and tidied, vegetation cut back where required

Remove barriers, replace with single bollard if required to prevent vehicle access

Existing 3m Redway to be refreshed/resurfaced where required

Junction priority and wayfinding to be provided

Junction priority and wayfinding to be provided

P01	FOR APPROVAL	AH	BB	-	18.08.23
REV	DESCRIPTION	DRN	CHK	APP	DATE

**Pell Frischmann**  
 SUITE 109, PLAZA 668, HITCHIN ROAD, BEDFORDSHIRE LU2 7XH  
 Telephone +44 (0)158 232 1222  
 Email: pfluton@pellfrischmann.com  
 www.pellfrischmann.com

Architect/Client/Contractor  
**MILTON KEYNES COUNCIL**

Project  
**MILTON KEYNES LOCAL WALKING & CYCLING INFRASTRUCTURE PLAN**

Drawing Title  
**SCHEME NO.164 (SHEET 2 OF 2) RAILWAY WALK NEWPORT FEASIBILITY DRAWING**

Drawing Status			
<b>FOR APPROVAL</b>			
Drawn	Name	Date	Status Code
Designed	SL	18.08.23	S4
Eng Chk	BB	18.08.23	Scale
Approved	-	-	1:1000
Drawing No.	Revision		P01

106346 - PEF-GA- ZZ - DR - D -0164-2