

EXAMPLE OF TYPICAL SECTION THROUGH A 3m REDWAY

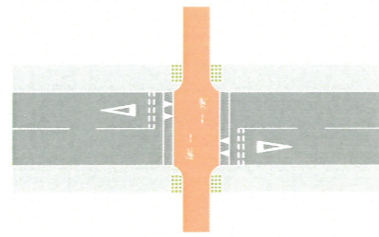

EXAMPLE OF A CYCLE PRIORITY CROSSING AS FIGURE 10.6 OF LTN 1/20

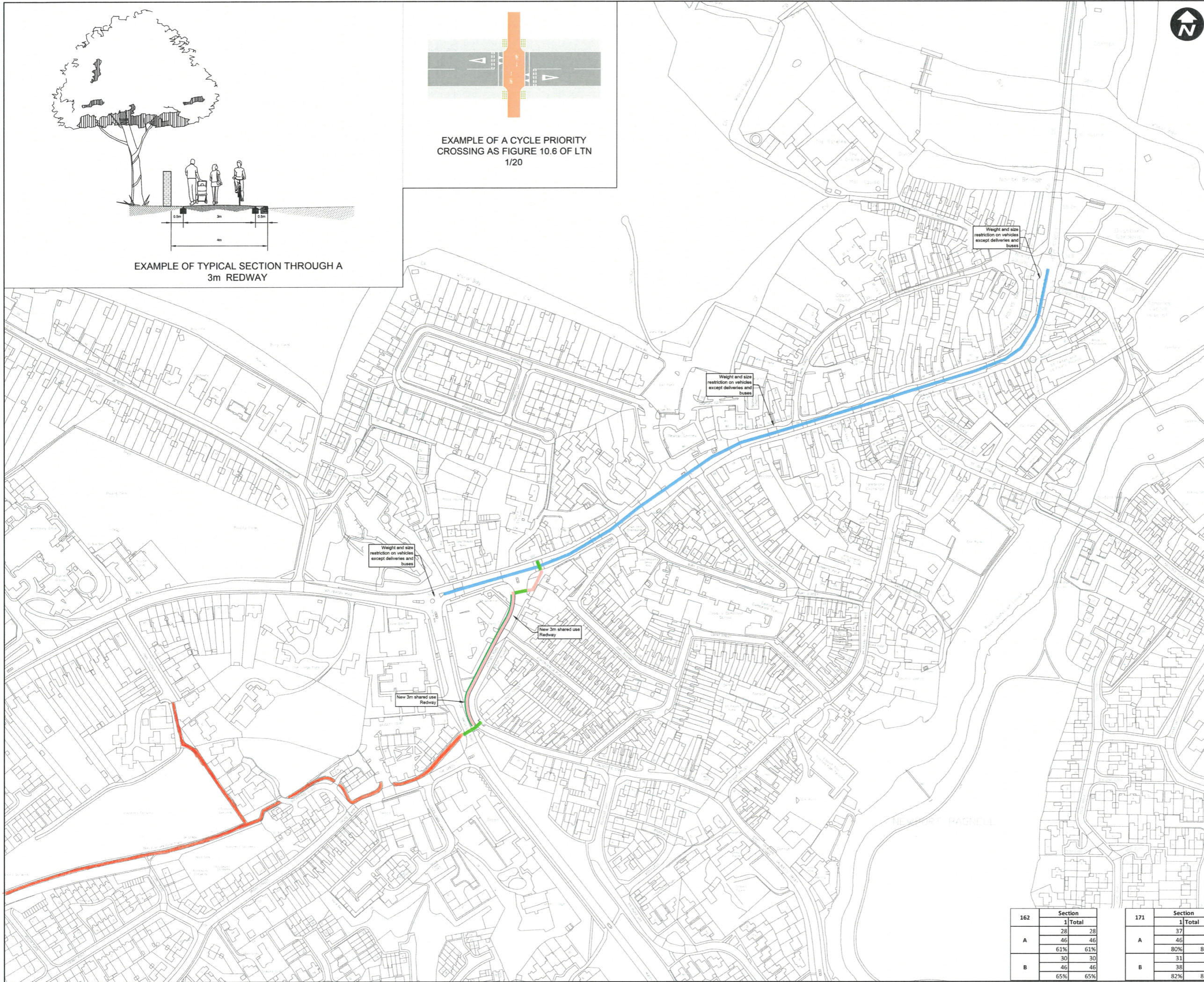

- GENERAL NOTES**
- G1. DO NOT SCALE THIS DRAWING.
 - G2. ANY DIMENSIONAL DISCREPANCIES SHOULD BE NOTIFIED TO THE ENGINEER IMMEDIATELY.
 - G3. ALL DIMENSIONS ARE IN MILLIMETRES - (mm)
 - G4. ALL LEVELS ARE IN METRES - (m) AND ARE ABOVE ORDNANCE DATUM AT NEWLYN, CORNWALL UNLESS NOTED OTHERWISE.
 - G5. NORTH SHOWN INDICATIVE ONLY
 - G6. THIS DRAWING IS TO BE READ IN CONJUNCTION WITH ALL RELEVANT SPECIFICATIONS, DRAWINGS, DETAILS AND OTHER DESIGN INFORMATION.
 - G7. ALL DRAWINGS AND WRITTEN MATERIAL CONTAINED WITHIN, CONSTITUTE ORIGINAL AND UNPUBLISHED WORK OF THE ENGINEER AND MAY NOT BE DUPLICATED, USED, REPRODUCED OR DISCLOSED WITHOUT WRITTEN CONSENT OR EXPRESS PERMISSION FROM THE ENGINEER.
 - G8. WHERE THE CONTRACTOR UNDERTAKES OR ENGAGES A THIRD PARTY TO UNDERTAKE TEMPORARY WORKS DESIGN, OR VARIES THE PELL FRISCHMANN DESIGN IN ANY WAY, THEN THE CONTRACTOR WILL TAKE FULL RESPONSIBILITY AND LIABILITY FOR ALL DESIGN ASPECTS, INCLUDING A DESIGN RISK ASSESSMENT. THE CONTRACTOR SHALL INFORM PELL FRISCHMANN OF ANY PROPOSED VARIANCES TO THE DESIGN.

- KEY:**
- █ Crossing point
 - █ Quiet Street
 - █ 3m Shared Use Pathway
 - New Kerb Alignment Required
 - Separation Strip
 - █ Existing redway

OPTION B

| | | | | |
|-----|--------------|-----|-----|----------|
| P01 | FOR APPROVAL | AH | BB | 18.08.23 |
| REV | DESCRIPTION | DRN | CHK | APP |

Pell Frischmann
 SUITE 109, PLAZA 668, HITCHIN ROAD, BEDFORDSHIRE LU2 7XH
 Telephone +44 (0)1582 232 222
 Email: pfluton@pellfrischmann.com
 www.pellfrischmann.com

Architect/Client/Contractor
MILTON KEYNES COUNCIL

Project
MILTON KEYNES LOCAL WALKING & CYCLING INFRASTRUCTURE PLAN

Drawing Title
SCHEME NO.162 & 171 STATION ROAD FEASIBILITY DRAWING

Drawing Status
FOR APPROVAL

| 162 | Section | |
|-----|---------|-------|
| | 1 | Total |
| | 28 | 28 |
| A | 46 | 46 |
| | 61% | 61% |
| | 30 | 30 |
| B | 46 | 46 |
| | 65% | 65% |

| 171 | Section | |
|-----|---------|-------|
| | 1 | Total |
| | 37 | 37 |
| A | 46 | 46 |
| | 80% | 80% |
| | 31 | 31 |
| B | 38 | 38 |
| | 82% | 82% |

| Name | Date | Status Code |
|------|----------|--------------|
| AH | 18.08.23 | S4 |
| SL | 18.08.23 | Scale 1:1000 |
| BB | 18.08.23 | Revision P01 |

Drawing No. **106346-PEF-GA-ZZ-DR-D-2171-1**