

PUBLIC PATH DIVERSION ORDER

HIGHWAYS ACT 1980

MILTON KEYNES CITY COUNCIL (HANSLOPE FOOTPATH 11 (PART)) PUBLIC PATH DIVERSION ORDER 2023

This Order is made by Milton Keynes City Council (“the authority”) under section 119 of the Highways Act 1980 (“the 1980 Act”) because it appears to the authority that in the interests of the owner of the land crossed by the footpath described in paragraph 1 of this Order it is expedient that the line of the footpath should be diverted.

The Applicant has agreed to defray any expenses which are incurred in bringing the new site of the path into a fit condition for use by the public.

BY THIS ORDER:

1. The public right of way over the land situate at Hanslope and shown by a bold black continuous line on the map contained in this Order and described in Part 1 of the Schedule to this Order shall be stopped up from the date of confirmation of this Order.
2. Notwithstanding this Order, where immediately before the date on which the footpath is diverted, there is apparatus under, in, on, over, along or across the path belonging to statutory undertakers for the purpose of carrying out their undertaking, the undertakers shall continue to have the same rights in respect of their apparatus as they then had.
3. There shall be from the date of confirmation of this Order public footpath over the land situate at Hanslope described in Part 2 of the Schedule to

479500

479600

479700

479800

479900

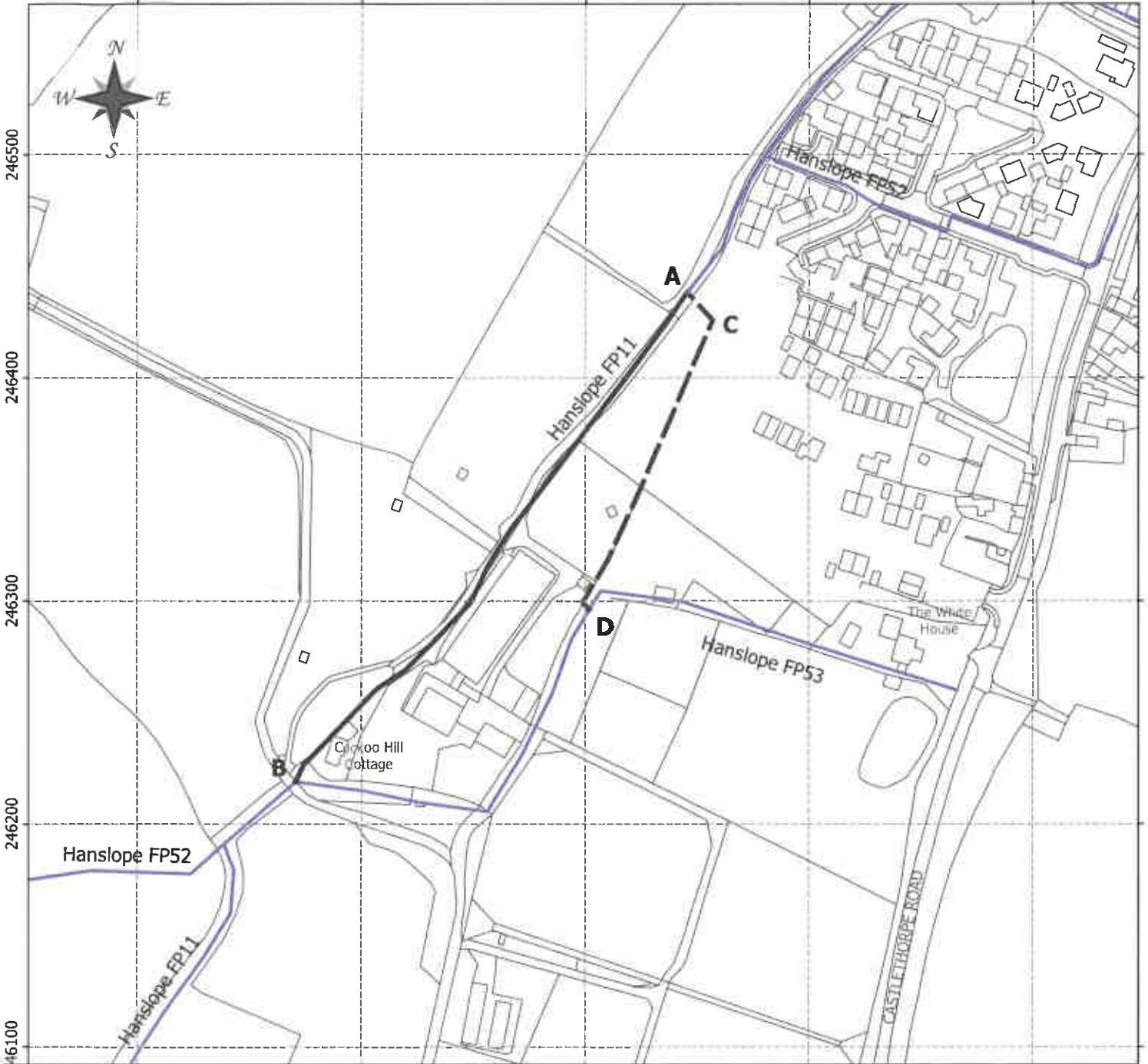

Map referred to in Milton Keynes City Council
 (Hanslope Footpath 11 (part)), Public Path Diversion Order 2023

The common seal of Milton Keynes City Council
 was hereunto affixed in the presence of:

CATHERINE STEPHENS
 AUTHORISED SIGNATORY

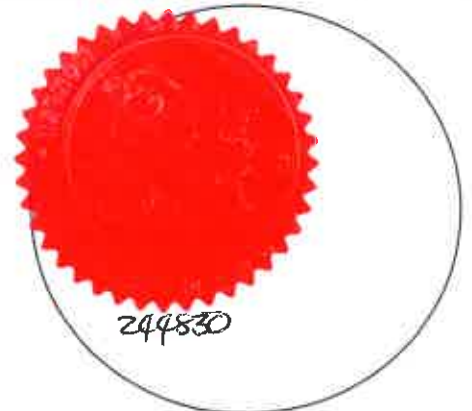

Key:

- A - B Proposed Extinguished
- A - C - D Proposed Diversion
- Unaffected Public Footpath
- Unaffected Public Bridleway

Scale
 1:2,500
 @A4P



© Crown copyright and database rights 2023
 OS [100019593]

Date Created: 8.3.2023

Created By: Katherine Robbins

this Order and shown by a bold black broken line on the map contained in this Order.

SCHEDULE

PART 1

Description of site of existing path or way

Existing Hanslope Footpath 11 (Part):-

From point A at O.S Grid Reference SP 79745 46438 in a general south westerly direction for approximately 282 metres to point B at O.S Grid Reference SP 79570 46219 and is shown by a bold black continuous line on the map (points A-B)

PART 2

Description of site of new path or way

New Hanslope Footpath 11 (Part):-

From point A at O.S Grid Reference SP 79745 46438 in a general south easterly direction for approximately 17 metres to point C at OS Grid Reference SP 79757 46426, then in a general south westerly direction for approximately 145 metres to point D at OS Grid Reference SP 79702 246295. The footpath will have a length of approximately 162 metres and a width of 2 metres throughout and is shown by a bold black dashed line on the map (points A-C-D)

THE COMMON SEAL of MILTON KEYNES CITY COUNCIL

was hereunto affixed this 14th day of March 2023

in the presence of: -

.....CATHERINE STEPHENS.....

AUTHORISED SIGNATORY

