

MILTON KEYNES CITY COUNCIL

(THE COUNCIL OF THE BOROUGH OF MILTON KEYNES) (VARIOUS ROADS, OLNEY) (CONSOLIDATION OF PARKING, WAITING AND LOADING RESTRICTIONS) ORDER 2014) VARIATION ORDER 2025

Milton Keynes City Council ("the Council") in exercise of its powers under sections 1(1), 2(1) and (2), 4(2), and Part IV of Schedule 9 of the Road Traffic Regulation Act 1984 ("the Act of 1984") and of all other enabling powers, and after consultation with the chief officer of Police in accordance with Part III of Schedule 9 to the Act of 1984, hereby makes the following Order:-

PART 1

IMPLEMENTATION AND CITATION

1. This Order shall come into operation on the day of 2025 and may be cited as "Milton Keynes City Council (The Council of the Borough of Milton Keynes) (Various Roads, Olney) (Consolidation of Parking, Waiting and Loading Restrictions) Order 2014) Variation Order 2025".
2. Any reference in this Order to any enactment shall be construed as a reference to that enactment as amended by any subsequent enactment.
3. The plan annexed to this Order identifies the lengths of road subject to this Order, provided that where there is any inconsistency between the plan and Schedules it is the wording of the Schedules which shall prevail.
4. The plan annexed to this Order is hereby annexed to The Council of the Borough of Milton Keynes (Various Roads, Olney) (Consolidation of Parking, Waiting and Loading Restrictions) Order 2014 and form part of that Order.

PART 2

VARIATIONS

5. The Council of the Borough of Milton Keynes (Various Roads, Olney) (Consolidation of Parking, Waiting and Loading Restrictions) Order 2014 ("The Principal Order") is varied as provided by the following provisions of this Order: -

6. The following items are inserted into Schedule 1 of the Principal Order: -

YARDLEY ROAD, OLNEY

NORTH SIDE

NW93 From its junction with Drift Way, for a distance of 100 metres in a south-easterly direction.

FAIRFIELD CLOSE AND EAST STREET, OLNEY

NORTH SIDE AND EAST SIDE

NW94 From a point on Fairfield Close 12 metres east of its junction with East Street, for a distance of 27 metres in a westerly the northerly direction onto East Street.

FAIRFIELD CLOSE AND EAST STREET, OLNEY

SOUTH SIDE AND EAST SIDE

NW95 From a point on Fairfield Close 12 metres east of its junction with East Street, for a distance of 27 metres in a westerly the southerly direction onto East Street.

PALMERS ROAD, OLNEY

NORTH-EAST SIDE

NW96 From its junction with the southern kerbline of Near Town, for a distance of 36 metres in a south-easterly direction.

--- END ---

THE COMMON SEAL of **MILTON**
KEYNES CITY COUNCIL as hereunto
affixed this day of 2025 in the
presence of: -

.....
HEAD OF LEGAL SERVICES

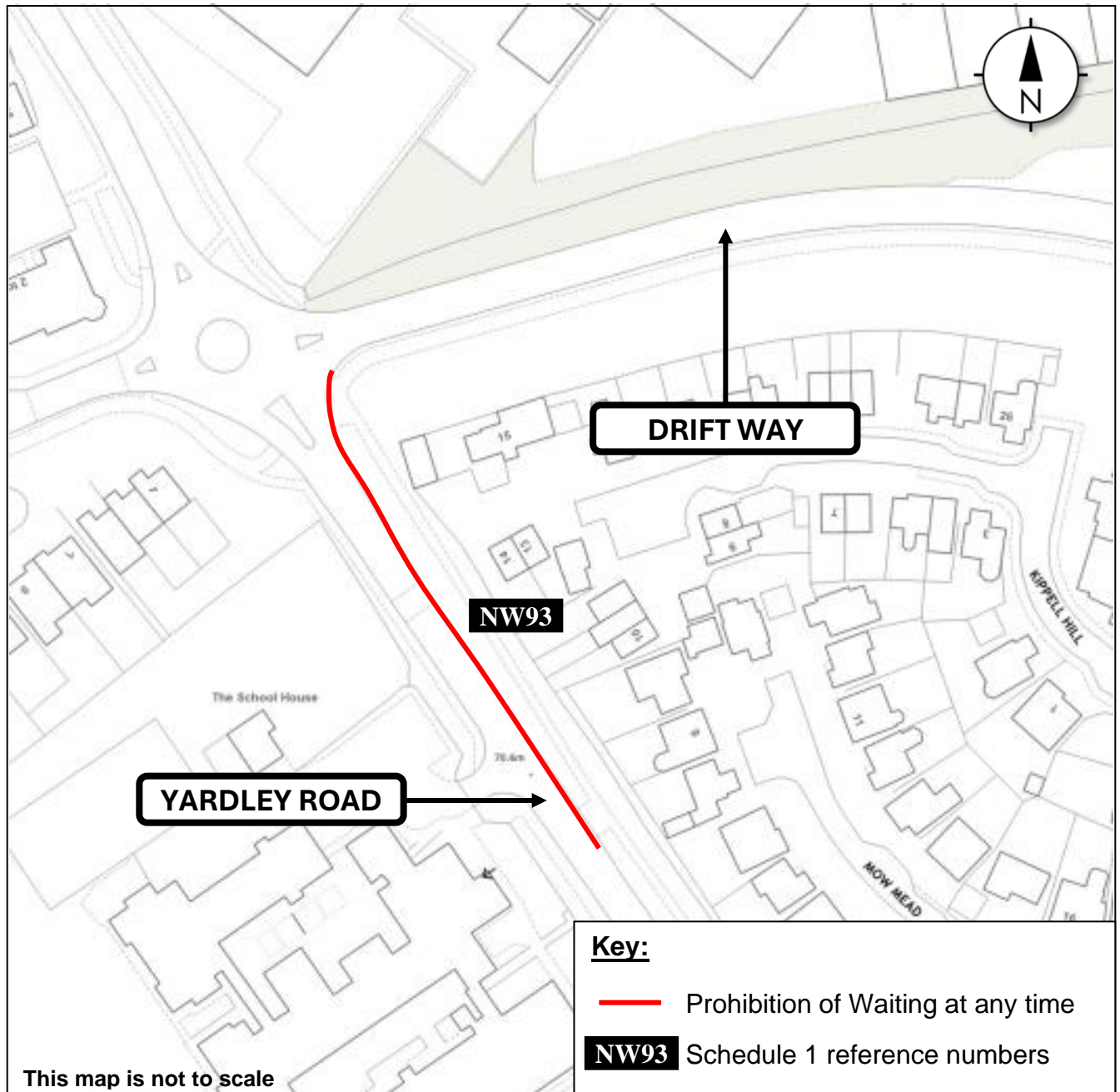

Map referred to in Milton Keynes City Council (The Council of the Borough of Milton Keynes) (Various Roads, Olney) (Consolidation of Parking, Waiting and Loading Restrictions) Order 2014) Variation Order 2025

The Common Seal of the Council of the Borough of Milton Keynes was hereunto affixed in the presence of:

.....
HEAD OF LEGAL SERVICES

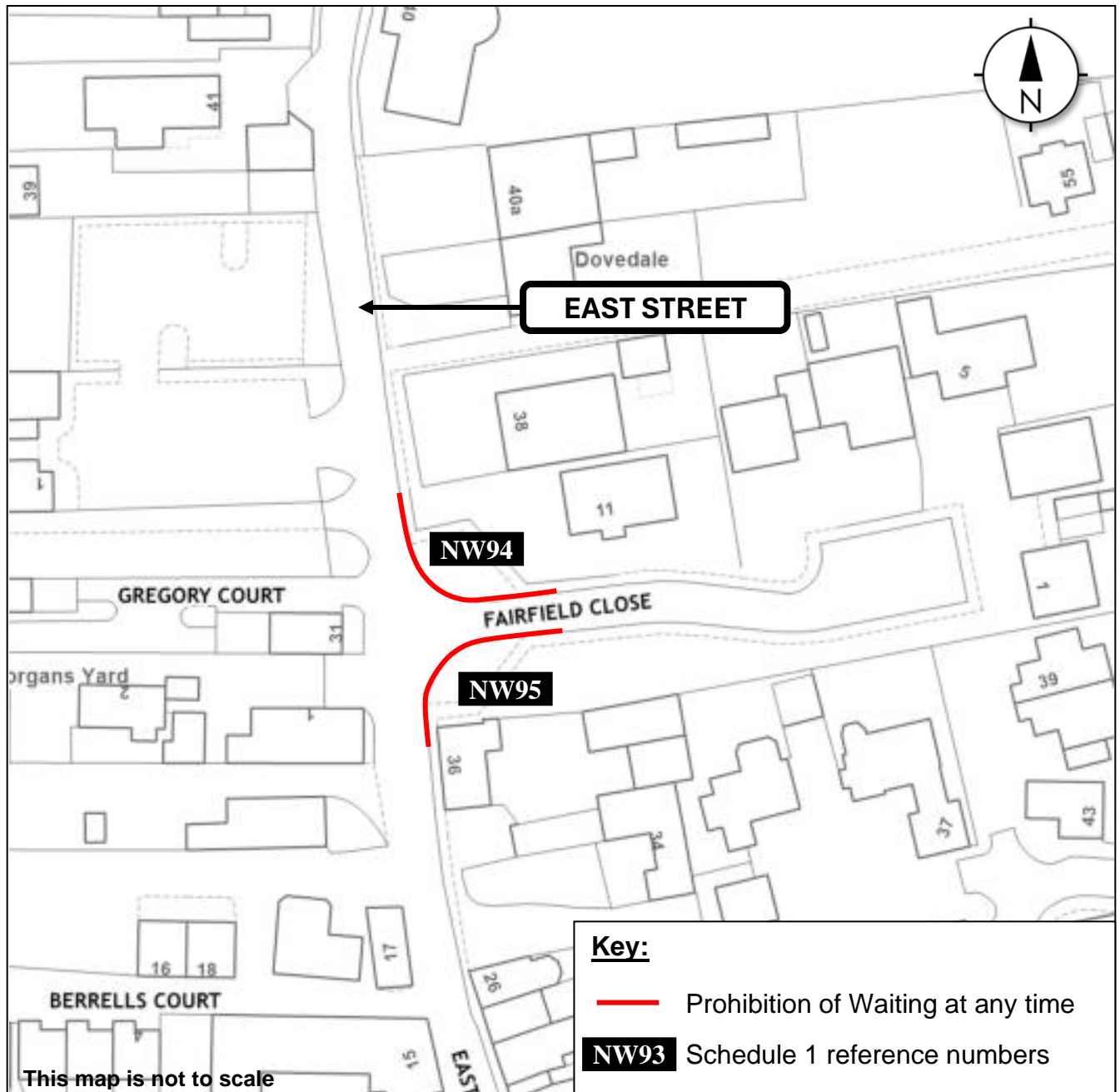

Map referred to in Milton Keynes City Council (The Council of the Borough of Milton Keynes) (Various Roads, Olney) (Consolidation of Parking, Waiting and Loading Restrictions) Order 2014) Variation Order 2025

The Common Seal of the Council of the Borough of Milton Keynes was hereunto affixed in the presence of:

.....
HEAD OF LEGAL SERVICES

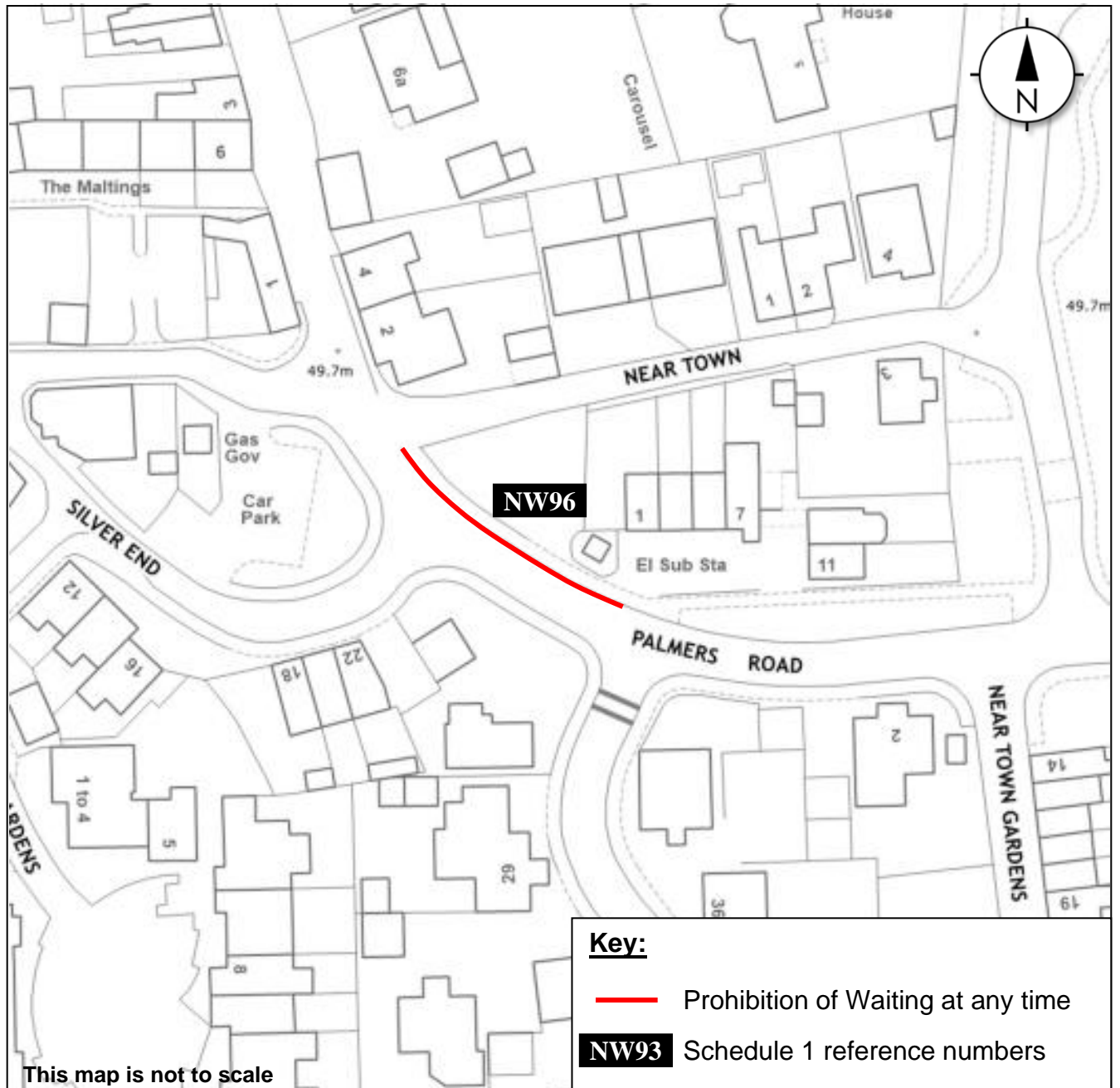

Map referred to in Milton Keynes City Council (The Council of the Borough of Milton Keynes) (Various Roads, Olney) (Consolidation of Parking, Waiting and Loading Restrictions) Order 2014) Variation Order 2025

The Common Seal of the Council of the Borough of Milton Keynes was hereunto affixed in the presence of:

.....
HEAD OF LEGAL SERVICES