

**Drain Type D2**  
All pipes

**Drain Type D3**  
Concrete, clay or plastic

**Drain Type D4**  
Concrete, clay and plastic  
(concrete slab alternative)

- Key:**
- Type 1 sub-base or 6F capping compacted in 225 layers
  - Granular pipe bedding to MCHW CC 500 Cl. 1
  - ST4 concrete bedding

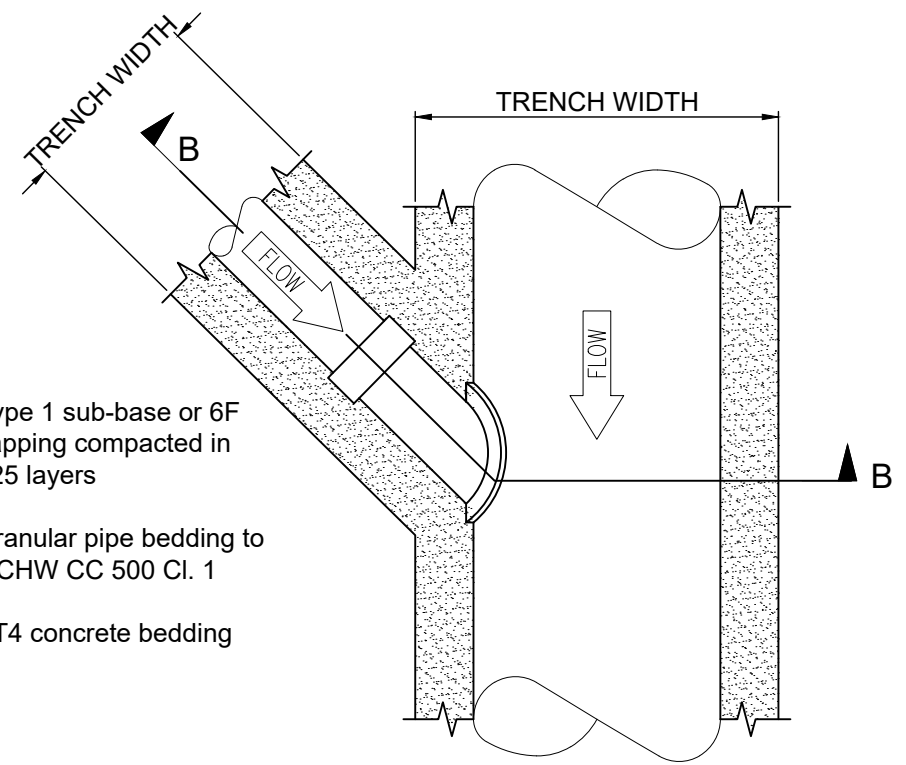

**Granular Surround**

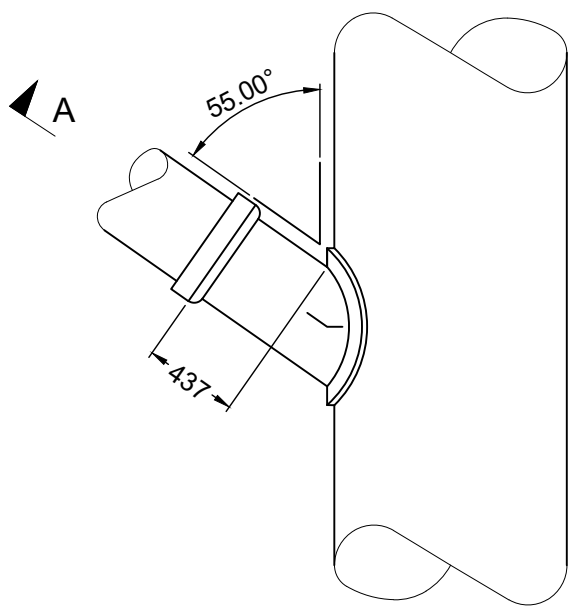

**Concrete Surround**

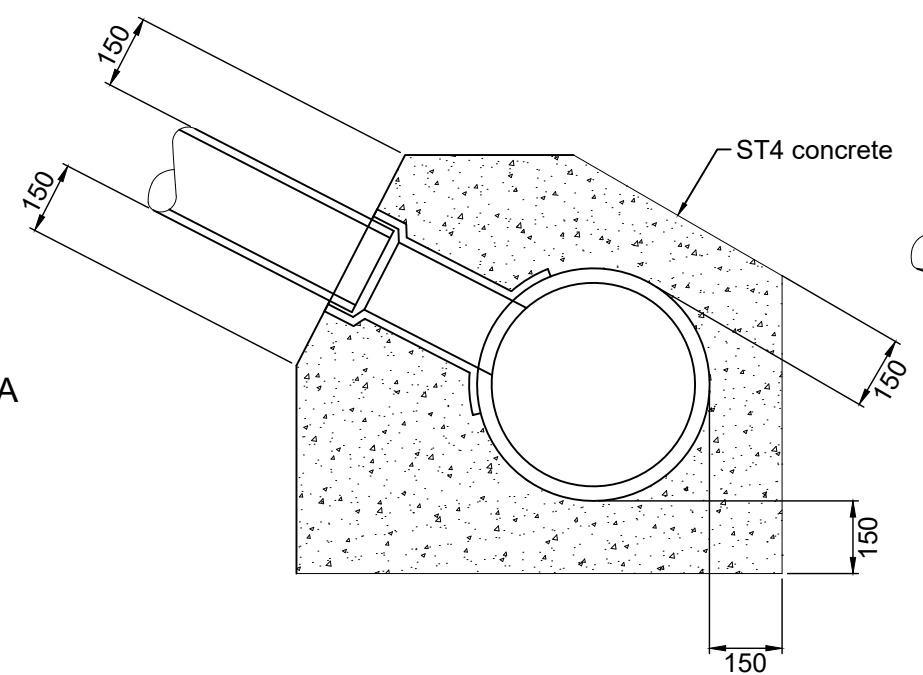

**Section A - A**  
**Concrete Surround**

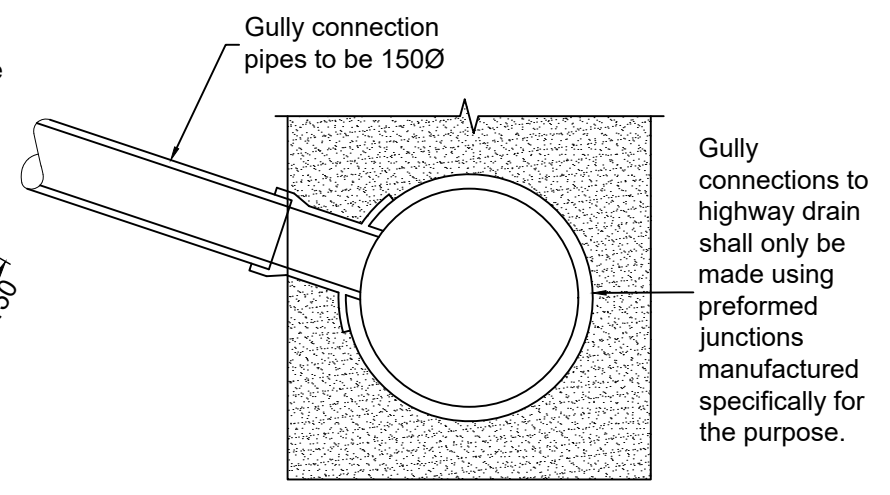

**Section B - B**  
**Granular Surround**

**NOTES**

1. All dimensions in millimetres unless shown otherwise.
2. Acceptable pipe material shall be:
  - Vitrified clay pipes to BS 65.
  - Concrete pipes to BS EN 1916.
  - Thermoplastic pipes to MCHW Cl. 1.35, 1.36, 2.31, 2.32 & 2.33 (minimum SDR34)
3. Pipe and bedding and materials must not be changed between chambers.
4. Pipes with Diameter greater than 900 must comply with the requirements of DMB CG300.
5. For further information refer to Standard Detail Guidance Note drawing no. MKCC-100-001.

**MK Milton Keynes City Council**  
Highways and Transportation  
Civic Offices  
1 Saxon Gate East  
Central Milton Keynes  
MK9 3EJ

<b>DRAWING TITLE:</b> Drain Types Under and Within 1m of a Paved Area												
<b>SCALE:</b> NTS	<b>REV:</b> P01	<b>DRAWN:</b> PG	<b>CHECKED:</b> JM	<b>APPROVED:</b> LS	<b>REV:</b>	<b>AMENDMENTS:</b>	<b>DRN:</b>	<b>CHCK'D:</b>	<b>APPR'D:</b>	<b>DATE:</b>		
		<b>INITIALS:</b>			<b>DRAWING NO:</b> MKCC-500-004							
		<b>DATE:</b>	17/02/2026	17/03/2026	17/03/2026							

