

Duct in verge or footway
(More than 600 cover to pipe crown)

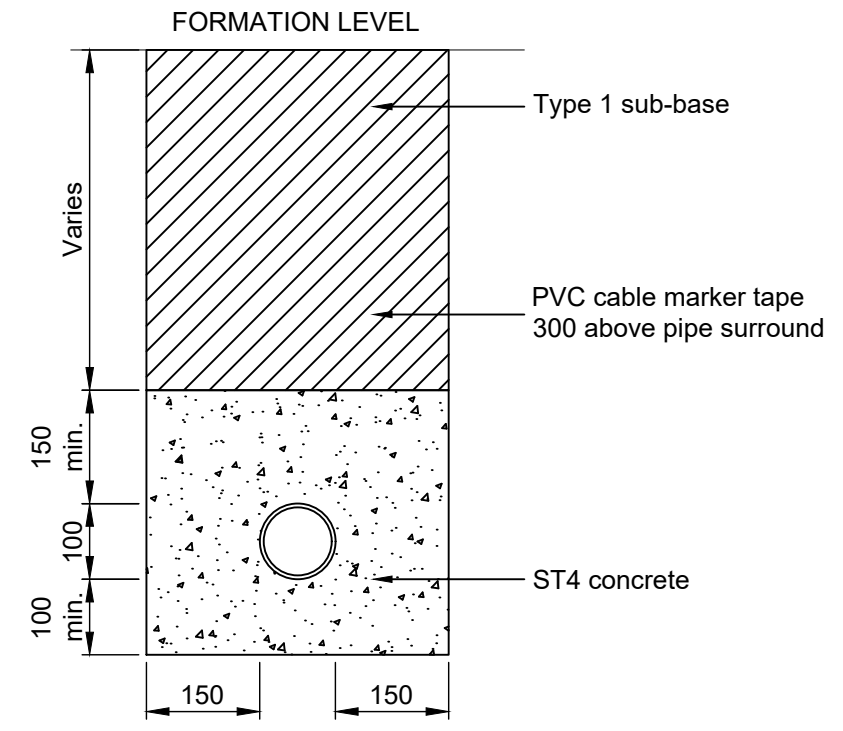

Duct in carriageway and verge or footway
(Less than 600 cover to pipe crown)

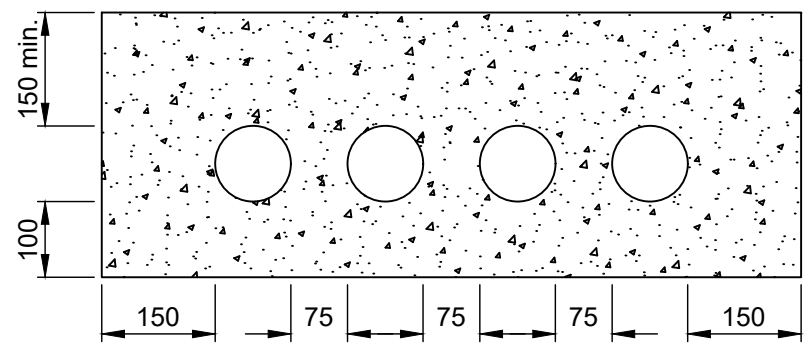

Typical layout for 2 or more ducts

NOTES

1. All dimensions in millimetres unless shown otherwise.
2. Acceptable pipe material shall be:
 - Vitrified clay pipes to BS 65.
 - Concrete pipes to BS EN 1916.
 - Thermoplastic pipes to MCHW Cl. 1.35, 1.36, 2.31, 2.32 & 2.33 (minimum SDR34)
3. Pipe and bedding and materials must not be changed between chambers.
4. For further information refer to Standard Detail Guidance Note drawing no. MKCC-100-001.

MK Milton Keynes City Council
Highways and Transportation
Civic Offices
1 Saxon Gate East
Central Milton Keynes
MK9 3EJ

DRAWING TITLE: Service Ducting											
SCALE: NTS	REV: P01	DRAWN: PG	CHECKED: JM	APPROVED: LS	REV: -	AMENDMENTS: -	DRN: -	CHCK'D: -	APPR'D: -	DATE: -	
INITIALS:					DRAWING NO: MKCC-500-006						
DATE:		17/02/2026	17/03/2026	17/03/2026							

